



iJOINT Compression Fittings

4



Tapping Saddles

24



Clamp Saddles

26

Index

38

The iJOINT focuses on safety and ergonomic handling – real benefits for our customers

The line of compression fittings from GF Piping Systems has been specially developed for use in water systems, assuring a quicker and easier installation compared to a traditional compression fitting. The lip sealing system makes this product both unique and long-lasting. Superb quality and innovative features predestine iJOINT for the drinking water market worldwide. iJOINT comprises all the benefits of plastics: no rust and no incrustation, lightweight construction, no leakage, excellent pressure resistance – just to name a few.

+ Features



iJOINT – the next generation of polypropylene compression fittings

+ Benefits



Fast and easy installation

iJOINT comes ready for installation, if necessary unscrew the nut to obtain a very easy pipe insertion. Installation of bigger dimensions is even easier due to the fact that there is no contact between the clamp ring and the pipe during insertion. No special tools or equipment are required for the installation.



Lip gasket

The special lubricated NBR lip gasket allows a smooth pipe insertion even without pre-lubrication of the pipe. The special lip profile provides outstanding hydraulic performance even in case of ovalized, scratched or undersized pipes.

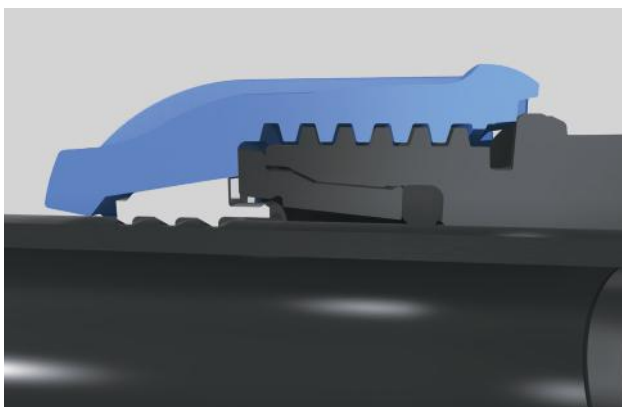



Safe design and long life time

The special design in combination with the use of top quality raw materials enables high pressure and pull-out resistance throughout the complete range, also in case of water hammer. The grip ring is biting the pipe granting a high pull out resistance and the thrust ring is pushing the lip gasket towards the pipe for a perfect sealing resistance.

Conformity to all important standards and availability in a wide range of diameters makes iJOINT your first choice

iJOINT compression fittings are suitable for use with all types of polyethylene pipes PE 80, PE 100, PEX and PVC-U with special transition kit. The fitting is ready to be installed out of the box without any preparation. The pipe can be inserted directly without disassembling the fitting. There is a 16 bar resistance throughout the complete range of iJOINT fittings, with approvals according to the most stringent regulations worldwide. The special lip gasket grants a perfect performance even with ovalised, scratched and undersized pipes.

+ Technical specifications

| | | |
|---|--|--|
| <p>From ø 20 to 63</p>  | <p>Pressure range MOP of 16 bar for the complete range of iJOINT fittings from d20 to d110 mm (complete range DVGW approved PN16)</p> <p>Temperature range -10 °C to +45 °C</p> <p>Materials</p> <p>Body and thrust ring UV stabilized polypropylene impact Copolymer with high long term aging stability complying with ISO 9080.</p> <p>Nut UV stabilized blue polypropylene Impact Copolymer</p> <p>Clamp ring Polyacetal (POM)</p> <p>Lubricated lip gasket Food-safe NBR rubber suitable for potable water.</p> <p>Reinforcement ring (for female thread) Stainless steel AISI 430</p> <p>Regulation for drinking water iJOINT compression fittings comply with the strictest worldwide regulations, e.g.: – DVGW GW 335-B3 – W270 and KTW (Germany) – ATA (Netherlands) – DM 174-06/04/2004 (Italy) – Global Mark (Australia) – ACS (France)</p> <p>Approvals – DVGW (Germany) – IIP (Italy) – SVGW (Switzerland) – KIWA (Netherlands) – ACS (France) – Global Mark (Australia)</p> <p>Standards</p> <p>For PE pipes: DIN EN 12201; ISO 11922-1; DIN 8074; EN 12201-1/2; AS/NZS 4130; BS 6572; BS 6730; ISO 4427; UNI 7990; ISO 12162</p> <p>Threads DIN EN 10226 (ISO 7-1); BS 21; AS 1722.1</p> <p>Flanges DIN EN1092-1; DIN 2501.1</p> <p>Test standards ISO 14236; DIN 8076-3; AS/NZS 4129; BRL K534/03 –UNI; ISO 3501; ISO 3503; ISO 3458; ISO 3459; VP609</p> | <p>From ø 75 to 110</p>  |
|---|--|--|

The comprehensive iJOINT system is ideal for new installations as well as renovations or extensions of existing water lines

iJOINT is designed for use in house connections and service lines. This wide-ranging system lends itself to new installations as well as to renovation or extension work on existing water lines. iJOINT can be used for diverse applications and its design benefits a vast number of industries. In addition, iJOINT is the perfect solution for bypass systems, where temporarily laid lines need to be disassembled in a quick and easy way.

+ Applications



Water Distribution Lines



House Connections



High-end Irrigation



- Water Distribution Lines
- House Connections and Service Lines
- Pressure Sewage

- Industrial Applications
- Mining Industry

- Leisure Parks
- Golf Courses
- Camping Grounds

- Farming
- Greenhouses
- High-end Irrigation

iJOINT Compression Fittings

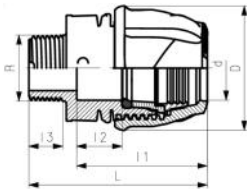

Male adaptor

- installation without disassembling
- suitable for PE and PEX pipes
- water PN16
- material: PP
- gasket: NBR quality for drinkable water
- male thread: ISO 7 (conical)
- colour: blue-black

| d | R | PN | Code | PF | SP | GP | Weight | D | L | L1 | L2 | L3 |
|------|--------|-------|--------------------|--------------|----|-----|--------|------|------|------|------|------|
| (mm) | (inch) | (bar) | | | | | (kg) | (mm) | (mm) | (mm) | (mm) | (mm) |
| 16 | ½ | 16 | 158 400 351 | 2 85 A07 020 | 1 | 75 | 0.037 | 45 | 73 | 46 | 19 | 14 |
| 16 | ¾ | 16 | 158 400 352 | 2 85 A07 020 | 1 | 75 | 0.040 | 51 | 74 | 46 | 19 | 14 |
| 20 | ½ | 16 | 158 400 123 | 2 85 A07 001 | 1 | 220 | 0.037 | 45 | 73 | 54 | 19 | 14 |
| 20 | ¾ | 16 | 158 400 124 | 2 85 A07 001 | 1 | 220 | 0.040 | 45 | 74 | 54 | 19 | 15 |
| 20 | 1 | 16 | 158 400 125 | 2 85 A07 001 | 1 | 220 | 0.038 | 45 | 77 | 54 | 19 | 17 |
| 25 | ½ | 16 | 158 400 126 | 2 85 A07 001 | 1 | 180 | 0.050 | 53 | 79 | 59 | 21 | 14 |
| 25 | ¾ | 16 | 158 400 127 | 2 85 A07 001 | 1 | 180 | 0.056 | 53 | 80 | 59 | 21 | 15 |
| 25 | 1 | 16 | 158 400 128 | 2 85 A07 001 | 1 | 170 | 0.057 | 53 | 83 | 59 | 21 | 17 |
| 32 | ¾ | 16 | 158 400 129 | 2 85 A07 001 | 1 | 120 | 0.088 | 64 | 88 | 66 | 23 | 15 |
| 32 | 1 | 16 | 158 400 130 | 2 85 A07 001 | 1 | 120 | 0.091 | 64 | 91 | 66 | 23 | 17 |
| 32 | 1 ¼ | 16 | 158 400 131 | 2 85 A07 001 | 1 | 120 | 0.092 | 64 | 93 | 66 | 23 | 20 |
| 32 | 1 ½ | 16 | 158 400 132 | 2 85 A07 001 | 1 | 115 | 0.098 | 64 | 93 | 66 | 23 | 20 |
| 40 | 1 | 16 | 158 400 133 | 2 85 A07 001 | 90 | 0 | 0.136 | 75 | 102 | 76 | 26 | 17 |
| 40 | 1 ¼ | 16 | 158 400 134 | 2 85 A07 001 | 90 | 0 | 0.153 | 75 | 104 | 76 | 26 | 20 |
| 40 | 1 ½ | 16 | 158 400 135 | 2 85 A07 001 | 90 | 0 | 0.142 | 75 | 104 | 76 | 26 | 20 |
| 40 | 2 | 16 | 158 400 136 | 2 85 A07 001 | 80 | 0 | 0.154 | 75 | 109 | 76 | 26 | 24 |
| 50 | 1 | 16 | 158 400 137 | 2 85 A07 001 | 50 | 0 | 0.265 | 97 | 114 | 88 | 30 | 17 |
| 50 | 1 ¼ | 16 | 158 400 138 | 2 85 A07 001 | 50 | 0 | 0.267 | 97 | 117 | 88 | 30 | 20 |
| 50 | 1 ½ | 16 | 158 400 139 | 2 85 A07 001 | 50 | 0 | 0.247 | 97 | 117 | 88 | 30 | 20 |
| 50 | 2 | 16 | 158 400 140 | 2 85 A07 001 | 50 | 0 | 0.273 | 97 | 121 | 88 | 30 | 24 |
| 63 | 1 ½ | 16 | 158 400 141 | 2 85 A07 001 | 30 | 0 | 0.421 | 114 | 135 | 104 | 35 | 20 |
| 63 | 2 | 16 | 158 400 142 | 2 85 A07 001 | 30 | 0 | 0.437 | 114 | 139 | 104 | 35 | 24 |
| 63 | 2 ½ | 16 | 158 400 143 | 2 85 A07 001 | 25 | 0 | 0.427 | 114 | 143 | 104 | 35 | 28 |
| 75 | 2 | 16 | 158 400 144 | 2 85 A07 001 | 18 | 0 | 0.768 | 135 | 170 | 133 | 41 | 24 |
| 75 | 2 ½ | 16 | 158 400 145 | 2 85 A07 001 | 18 | 0 | 0.763 | 135 | 174 | 133 | 41 | 28 |
| 75 | 3 | 16 | 158 400 146 | 2 85 A07 001 | 18 | 0 | 0.791 | 135 | 177 | 133 | 41 | 30 |
| 90 | 2 | 16 | 158 400 147 | 2 85 A07 001 | 8 | 0 | 1.225 | 161 | 189 | 150 | 44 | 24 |
| 90 | 2 ½ | 16 | 158 400 148 | 2 85 A07 001 | 8 | 0 | 1.139 | 161 | 193 | 150 | 44 | 28 |
| 90 | 3 | 16 | 158 400 149 | 2 85 A07 001 | 8 | 0 | 1.144 | 161 | 196 | 150 | 44 | 30 |
| 90 | 4 | 16 | 158 400 150 | 2 85 A07 001 | 8 | 0 | 1.201 | 161 | 202 | 150 | 44 | 36 |
| 110 | 3 | 16 | 158 400 151 | 2 85 A07 001 | 6 | 0 | 1.831 | 185 | 222 | 175 | 53 | 30 |
| 110 | 4 | 16 | 158 400 152 | 2 85 A07 001 | 6 | 0 | 1.854 | 185 | 228 | 175 | 53 | 36 |

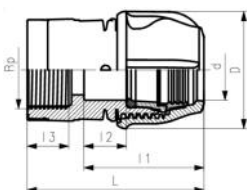

Female adaptor

- with stainless steel reinforcement ring (**AISI430**)
- installation without disassembling
- suitable for PE and PEX pipes
- water PN16
- material: PP
- gasket: NBR quality for drinkable water
- female thread: ISO 7 (parallel)
- colour: blue-black

| d | Rp | PN | Code | PF | SP | GP | Weight | D | L | L1 | L2 | L3 |
|------|--------|-------|--------------------|--------------|----|-----|--------|------|------|------|------|------|
| (mm) | (inch) | (bar) | | | | | (kg) | (mm) | (mm) | (mm) | (mm) | (mm) |
| 16 | ½ | 16 | 158 400 355 | 2 85 A07 020 | 1 | 75 | 0.040 | 44 | 74 | 46 | 19 | 15 |
| 20 | ½ | 16 | 158 400 088 | 2 85 A07 001 | 1 | 220 | 0.040 | 45 | 75 | 54 | 19 | 15 |
| 20 | ¾ | 16 | 158 400 089 | 2 85 A07 001 | 1 | 200 | 0.047 | 45 | 77 | 54 | 19 | 16 |
| 25 | ½ | 16 | 158 400 090 | 2 85 A07 001 | 1 | 175 | 0.059 | 53 | 81 | 59 | 21 | 15 |

table continued on the next page

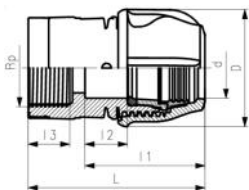

| d (mm) | Rp (inch) | PN (bar) | Code | PF | SP | GP | Weight (kg) | D (mm) | L (mm) | l1 (mm) | l2 (mm) | l3 (mm) |
|-----------|--------------|-------------|--------------------|--------------|----|-----|----------------|-----------|-----------|------------|------------|------------|
| 25 | ¾ | 16 | 158 400 091 | 2 85 A07 001 | 1 | 175 | 0.063 | 53 | 81 | 59 | 21 | 16 |
| 25 | 1 | 16 | 158 400 092 | 2 85 A07 001 | 1 | 150 | 0.072 | 53 | 87 | 59 | 21 | 20 |
| 32 | ¾ | 16 | 158 400 093 | 2 85 A07 001 | 1 | 110 | 0.095 | 64 | 90 | 66 | 23 | 16 |
| 32 | 1 | 16 | 158 400 094 | 2 85 A07 001 | 1 | 110 | 0.100 | 64 | 94 | 66 | 23 | 20 |
| 32 | 1 ¼ | 16 | 158 400 095 | 2 85 A07 001 | 1 | 100 | 0.116 | 64 | 97 | 66 | 23 | 22 |
| 40 | 1 | 16 | 158 400 096 | 2 85 A07 001 | 90 | 0 | 0.163 | 75 | 105 | 76 | 26 | 20 |
| 40 | 1 ¼ | 16 | 158 400 097 | 2 85 A07 001 | 90 | 0 | 0.164 | 75 | 107 | 76 | 26 | 22 |
| 40 | 1 ½ | 16 | 158 400 098 | 2 85 A07 001 | 90 | 0 | 0.175 | 75 | 108 | 76 | 26 | 22 |
| 50 | 1 | 16 | 158 400 099 | 2 85 A07 001 | 45 | 0 | 0.280 | 97 | 117 | 88 | 30 | 20 |
| 50 | 1 ¼ | 16 | 158 400 100 | 2 85 A07 001 | 45 | 0 | 0.287 | 97 | 119 | 88 | 30 | 22 |
| 50 | 1 ½ | 16 | 158 400 101 | 2 85 A07 001 | 45 | 0 | 0.291 | 97 | 119 | 88 | 30 | 22 |
| 50 | 2 | 16 | 158 400 102 | 2 85 A07 001 | 40 | 0 | 0.327 | 97 | 125 | 88 | 30 | 26 |
| 63 | 1 ½ | 16 | 158 400 103 | 2 85 A07 001 | 25 | 0 | 0.439 | 114 | 137 | 104 | 35 | 22 |
| 63 | 2 | 16 | 158 400 104 | 2 85 A07 001 | 25 | 0 | 0.461 | 114 | 141 | 104 | 35 | 26 |
| 63 | 2 ½ | 16 | 158 400 105 | 2 85 A07 001 | 18 | 0 | 0.530 | 114 | 148 | 104 | 35 | 31 |
| 75 | 2 | 16 | 158 400 106 | 2 85 A07 001 | 18 | 0 | 0.811 | 135 | 173 | 133 | 41 | 26 |
| 75 | 2 ½ | 16 | 158 400 107 | 2 85 A07 001 | 18 | 0 | 0.843 | 135 | 178 | 133 | 41 | 31 |
| 75 | 3 | 10 | 158 400 108 | 2 85 A07 001 | 16 | 0 | 0.906 | 135 | 183 | 133 | 41 | 34 |
| 90 | 2 | 16 | 158 400 109 | 2 85 A07 001 | 8 | 0 | 1.264 | 161 | 192 | 150 | 44 | 26 |
| 90 | 2 ½ | 16 | 158 400 110 | 2 85 A07 001 | 8 | 0 | 1.297 | 161 | 197 | 150 | 44 | 31 |
| 90 | 3 | 10 | 158 400 111 | 2 85 A07 001 | 8 | 0 | 1.354 | 161 | 199 | 150 | 44 | 34 |
| 110 | 3 | 10 | 158 400 112 | 2 85 A07 001 | 6 | 0 | 1.927 | 185 | 226 | 175 | 53 | 34 |
| 110 | 4 | 10 | 158 400 113 | 2 85 A07 001 | 6 | 0 | 2.009 | 185 | 232 | 175 | 53 | 40 |

PF 2 85 A07 001

Reducing coupling



- installation without disassembling
- suitable for PE and PEX pipes
- water PN16
- material: PP
- gasket: NBR quality for drinkable water
- colour: blue-black

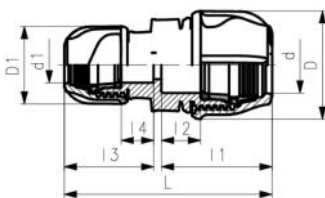

| d (mm) | d-d (mm) | PN (bar) | Code | SP | GP | Weight (kg) |
|-----------|-------------|-------------|--------------------|----|-----|----------------|
| 25 | 25 - 20 | 16 | 158 400 153 | 1 | 120 | 0.088 |
| 32 | 32 - 20 | 16 | 158 400 154 | 1 | 90 | 0.118 |
| 32 | 32 - 25 | 16 | 158 400 155 | 1 | 90 | 0.128 |
| 40 | 40 - 25 | 16 | 158 400 156 | 65 | 0 | 0.179 |
| 40 | 40 - 32 | 16 | 158 400 157 | 65 | 0 | 0.208 |
| 50 | 50 - 32 | 16 | 158 400 158 | 40 | 0 | 0.326 |
| 50 | 50 - 40 | 16 | 158 400 159 | 35 | 0 | 0.351 |
| 63 | 63 - 32 | 16 | 158 400 160 | 20 | 0 | 0.492 |
| 63 | 63 - 40 | 16 | 158 400 161 | 20 | 0 | 0.519 |
| 63 | 63 - 50 | 16 | 158 400 162 | 18 | 0 | 0.624 |
| 75 | 75 - 50 | 16 | 158 400 163 | 15 | 0 | 0.966 |
| 75 | 75 - 63 | 16 | 158 400 164 | 12 | 0 | 1.082 |
| 90 | 90 - 63 | 16 | 158 400 165 | 8 | 0 | 1.536 |
| 90 | 90 - 75 | 16 | 158 400 166 | 6 | 0 | 1.836 |
| 110 | 110 - 90 | 16 | 158 400 167 | 3 | 0 | 2.827 |

| d1 (mm) | D (mm) | D1 (mm) | L (mm) | l1 (mm) | l2 (mm) | l3 (mm) | l4 (mm) |
|------------|-----------|------------|-----------|------------|------------|------------|------------|
| 20 | 53 | 45 | 117 | 59 | 21 | 54 | 19 |
| 20 | 64 | 45 | 130 | 66 | 23 | 54 | 19 |
| 25 | 64 | 53 | 130 | 66 | 23 | 59 | 21 |
| 25 | 75 | 53 | 160 | 76 | 26 | 59 | 21 |
| 32 | 75 | 64 | 164 | 76 | 26 | 66 | 23 |
| 32 | 97 | 64 | 175 | 88 | 30 | 66 | 23 |
| 40 | 97 | 75 | 204 | 88 | 30 | 76 | 26 |
| 32 | 114 | 64 | 210 | 104 | 35 | 66 | 23 |
| 40 | 114 | 75 | 216 | 104 | 35 | 76 | 26 |

table continued on the next page

PF 2 85 A07 001

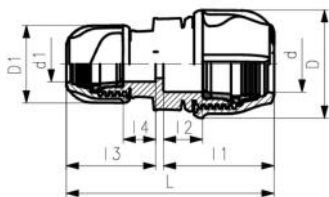

| d1 | D | D1 | L | l1 | l2 | l3 | l4 |
|------|------|------|------|------|------|------|------|
| (mm) | (mm) | (mm) | (mm) | (mm) | (mm) | (mm) | (mm) |
| 50 | 114 | 97 | 216 | 104 | 35 | 88 | 30 |
| 50 | 135 | 97 | 237 | 133 | 41 | 88 | 30 |
| 63 | 135 | 114 | 249 | 133 | 41 | 104 | 35 |
| 63 | 161 | 114 | 292 | 150 | 44 | 104 | 35 |
| 75 | 161 | 135 | 366 | 150 | 44 | 133 | 41 |
| 90 | 185 | 161 | 363 | 175 | 53 | 150 | 44 |



Coupling

- installation without disassembling
- suitable for PE and PEX pipes
- water PN16
- material: PP
- gasket: NBR quality for drinkable water
- colour: blue-black

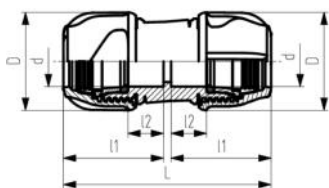

| d | PN | Code | PF | SP | GP | Weight | D | L | l1 | l2 |
|------|-------|--------------------|--------------|----|-----|--------|------|------|------|------|
| (mm) | (bar) | | | | | (kg) | (mm) | (mm) | (mm) | (mm) |
| 16 | 16 | 158 400 350 | 2 85 A07 020 | 1 | 50 | 0.066 | 45 | 112 | 46 | 19 |
| 20 | 16 | 158 400 001 | 2 85 A07 001 | 1 | 150 | 0.066 | 45 | 112 | 54 | 19 |
| 25 | 16 | 158 400 002 | 2 85 A07 001 | 1 | 100 | 0.095 | 53 | 123 | 59 | 21 |
| 32 | 16 | 158 400 003 | 2 85 A07 001 | 1 | 70 | 0.155 | 64 | 138 | 66 | 23 |
| 40 | 16 | 158 400 004 | 2 85 A07 001 | 55 | 0 | 0.237 | 75 | 157 | 76 | 26 |
| 50 | 16 | 158 400 005 | 2 85 A07 001 | 25 | 0 | 0.424 | 97 | 181 | 88 | 30 |
| 63 | 16 | 158 400 006 | 2 85 A07 001 | 15 | 0 | 0.727 | 114 | 213 | 104 | 35 |
| 75 | 16 | 158 400 007 | 2 85 A07 001 | 12 | 0 | 1.347 | 135 | 273 | 133 | 41 |
| 90 | 16 | 158 400 008 | 2 85 A07 001 | 4 | 0 | 2.164 | 161 | 306 | 150 | 44 |
| 110 | 16 | 158 400 009 | 2 85 A07 001 | 3 | 0 | 3.168 | 185 | 358 | 175 | 53 |

PF 2 85 A07 001



Repairing coupling (without pipe stop)

- installation without disassembling
- suitable for PE and PEX pipes
- water PN16
- material: PP
- gasket: NBR quality for drinkable water
- colour: blue-black

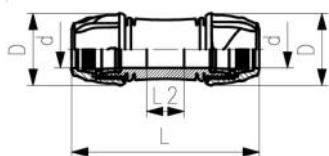

| d | PN | Code | SP | GP | Weight | D | L | l2 |
|------|-------|--------------------|----|-----|--------|------|------|------|
| (mm) | (bar) | | | | (kg) | (mm) | (mm) | (mm) |
| 20 | 16 | 158 400 168 | 1 | 140 | 0.071 | 45 | 129 | 21 |
| 25 | 16 | 158 400 169 | 1 | 100 | 0.107 | 53 | 144 | 25 |
| 32 | 16 | 158 400 170 | 1 | 50 | 0.171 | 63 | 165 | 33 |
| 40 | 16 | 158 400 171 | 35 | 0 | 0.275 | 75 | 193 | 41 |
| 50 | 16 | 158 400 172 | 24 | 0 | 0.488 | 97 | 225 | 50 |
| 63 | 16 | 158 400 173 | 14 | 0 | 0.879 | 114 | 270 | 63 |
| 75 | 16 | 158 400 174 | 8 | 0 | 1.574 | 135 | 340 | 74 |
| 90 | 16 | 158 400 175 | 4 | 0 | 2.329 | 161 | 394 | 90 |
| 110 | 16 | 158 400 176 | 2 | 0 | 3.793 | 185 | 464 | 110 |



90° Tee

- installation without disassembling
- suitable for PE and PEX pipes
- water PN16
- material: PP
- gasket: NBR quality for drinkable water
- colour: blue-black

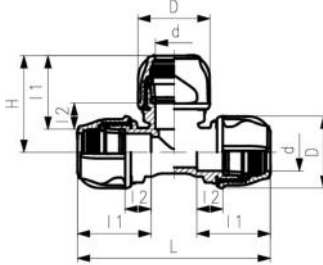

| d (mm) | PN (bar) | Code | PF | SP | GP | Weight (kg) | D (mm) | L (mm) | l1 (mm) | l2 (mm) | H (mm) |
|-----------|-------------|--------------------|--------------|----|-----|----------------|-----------|-----------|------------|------------|-----------|
| 16 | 16 | 158 400 354 | 2 85 A07 020 | 1 | 30 | 0.098 | 45 | 134 | 46 | 19 | 67 |
| 20 | 16 | 158 400 223 | 2 85 A07 001 | 1 | 100 | 0.098 | 45 | 134 | 54 | 19 | 67 |
| 25 | 16 | 158 400 224 | 2 85 A07 001 | 1 | 70 | 0.147 | 53 | 150 | 59 | 21 | 75 |
| 32 | 16 | 158 400 225 | 2 85 A07 001 | 1 | 40 | 0.238 | 64 | 173 | 66 | 23 | 87 |
| 40 | 16 | 158 400 226 | 2 85 A07 001 | 30 | 0 | 0.391 | 75 | 203 | 76 | 26 | 87 |
| 50 | 16 | 158 400 227 | 2 85 A07 001 | 12 | 0 | 0.753 | 97 | 239 | 88 | 30 | 119 |
| 63 | 16 | 158 400 228 | 2 85 A07 001 | 8 | 0 | 1.203 | 114 | 288 | 104 | 35 | 144 |
| 75 | 16 | 158 400 229 | 2 85 A07 001 | 5 | 0 | 2.207 | 135 | 360 | 133 | 41 | 180 |
| 90 | 16 | 158 400 230 | 2 85 A07 001 | 2 | 0 | 3.596 | 161 | 413 | 150 | 44 | 207 |
| 110 | 16 | 158 400 231 | 2 85 A07 001 | 1 | 0 | 5.342 | 185 | 484 | 175 | 53 | 242 |

PF 2 85 A07 001



90° Reducing-Increasing Tee

- installation without disassembling
- suitable for PE and PEX pipes
- water PN16
- material: PP
- gasket: NBR quality for drinkable water
- colour: blue-black

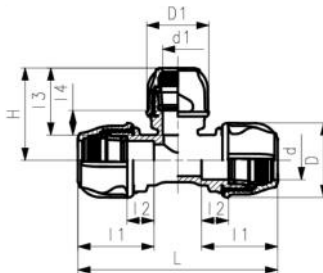

| d-d-d (mm) | PN (bar) | Code | SP | GP | Weight (kg) |
|----------------|-------------|--------------------|----|----|----------------|
| 20 - 25 - 20 | 16 | 158 400 200 | 1 | 75 | 0.100 |
| 25 - 20 - 25 | 16 | 158 400 232 | 1 | 75 | 0.133 |
| 25 - 32 - 25 | 16 | 158 400 201 | 1 | 50 | 0.181 |
| 32 - 25 - 32 | 16 | 158 400 233 | 1 | 45 | 0.213 |
| 40 - 32 - 40 | 16 | 158 400 234 | 30 | 0 | 0.348 |
| 50 - 32 - 50 | 16 | 158 400 235 | 15 | 0 | 0.596 |
| 50 - 40 - 50 | 16 | 158 400 236 | 12 | 0 | 0.643 |
| 63 - 32 - 63 | 16 | 158 400 237 | 8 | 0 | 0.948 |
| 63 - 50 - 63 | 16 | 158 400 238 | 8 | 0 | 1.076 |
| 75 - 63 - 75 | 16 | 158 400 239 | 5 | 0 | 1.915 |
| 90 - 75 - 90 | 16 | 158 400 240 | 2 | 0 | 3.196 |
| 110 - 63 - 110 | 16 | 158 400 241 | 1 | 0 | 4.148 |
| 110 - 90 - 110 | 16 | 158 400 242 | 1 | 0 | 4.865 |

| d-d-d (mm) | d (mm) | d1 (mm) | D (mm) | D1 (mm) | L (mm) | l1 (mm) | l2 (mm) | l4 (mm) | l3 (mm) | H (mm) |
|----------------|-----------|------------|-----------|------------|-----------|------------|------------|------------|------------|-----------|
| 20 - 25 - 20 | 20 | 25 | 45 | 53 | 134 | 54 | 19 | 59 | 21 | 81 |
| 25 - 20 - 25 | 25 | 20 | 53 | 45 | 150 | 59 | 21 | 54 | 19 | 71 |
| 25 - 32 - 25 | 25 | 32 | 53 | 64 | 150 | 59 | 21 | 66 | 23 | 93 |
| 32 - 25 - 32 | 32 | 25 | 64 | 53 | 173 | 66 | 23 | 59 | 21 | 81 |
| 40 - 32 - 40 | 40 | 32 | 75 | 64 | 203 | 76 | 26 | 66 | 23 | 93 |
| 50 - 32 - 50 | 50 | 32 | 97 | 64 | 239 | 88 | 30 | 66 | 23 | 99 |
| 50 - 40 - 50 | 50 | 40 | 97 | 75 | 239 | 88 | 30 | 76 | 26 | 109 |
| 63 - 32 - 63 | 63 | 32 | 114 | 64 | 288 | 104 | 35 | 66 | 23 | 108 |
| 63 - 50 - 63 | 63 | 50 | 114 | 97 | 288 | 104 | 35 | 88 | 30 | 129 |
| 75 - 63 - 75 | 75 | 63 | 135 | 114 | 360 | 133 | 41 | 104 | 35 | 157 |
| 90 - 75 - 90 | 90 | 75 | 161 | 135 | 413 | 150 | 44 | 133 | 41 | 196 |
| 110 - 63 - 110 | 110 | 63 | 185 | 144 | 484 | 175 | 53 | 104 | 35 | 182 |
| 110 - 90 - 110 | 110 | 90 | 185 | 161 | 484 | 175 | 53 | 150 | 44 | 224 |

PF 2 85 A07 001



90° Tee with threaded male off take

- installation without disassembling
- suitable for PE and PEX pipes
- water PN16
- material: PP
- gasket: NBR quality for drinkable water
- male thread: ISO 7 (conical)
- colour: blue-black

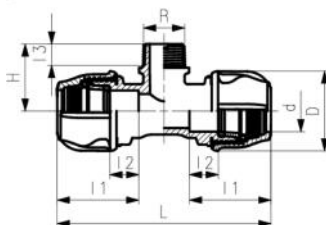

| d | R | PN | Code | SP | GP | Weight | D | L | I1 | I2 | I3 | H |
|------|--------|-------|-------------|----|-----|--------|------|------|------|------|------|------|
| (mm) | (inch) | (bar) | | | | (kg) | (mm) | (mm) | (mm) | (mm) | (mm) | (mm) |
| 20 | ½ | 16 | 158 400 202 | 1 | 120 | 0.072 | 45 | 134 | 54 | 19 | 14 | 41 |
| 20 | ¾ | 16 | 158 400 203 | 1 | 120 | 0.073 | 45 | 134 | 54 | 19 | 15 | 42 |
| 25 | ½ | 16 | 158 400 204 | 1 | 85 | 0.108 | 53 | 150 | 59 | 21 | 14 | 44 |
| 25 | ¾ | 16 | 158 400 205 | 1 | 85 | 0.110 | 53 | 150 | 59 | 21 | 15 | 46 |
| 25 | 1 | 16 | 158 400 206 | 1 | 80 | 0.115 | 53 | 150 | 59 | 21 | 17 | 48 |
| 32 | ¾ | 16 | 158 400 207 | 1 | 60 | 0.178 | 64 | 173 | 66 | 23 | 15 | 51 |
| 32 | 1 | 16 | 158 400 208 | 1 | 55 | 0.179 | 64 | 173 | 66 | 21 | 17 | 53 |
| 40 | ¾ | 16 | 158 400 209 | 45 | 0 | 0.282 | 75 | 203 | 76 | 26 | 15 | 57 |
| 40 | 1 ¼ | 16 | 158 400 210 | 30 | 0 | 0.297 | 75 | 203 | 76 | 26 | 20 | 62 |
| 40 | 1 ½ | 16 | 158 400 211 | 30 | 0 | 0.300 | 75 | 203 | 76 | 26 | 20 | 62 |
| 50 | ¾ | 16 | 158 400 212 | 16 | 0 | 0.532 | 97 | 239 | 88 | 30 | 15 | 65 |
| 50 | 1 ¼ | 16 | 158 400 213 | 16 | 0 | 0.501 | 97 | 239 | 88 | 30 | 20 | 70 |
| 50 | 1 ½ | 16 | 158 400 214 | 16 | 0 | 0.557 | 97 | 239 | 88 | 30 | 20 | 70 |
| 63 | 1 ¼ | 16 | 158 400 215 | 8 | 0 | 0.874 | 114 | 288 | 104 | 35 | 20 | 81 |
| 63 | 1 ½ | 16 | 158 400 216 | 8 | 0 | 0.905 | 114 | 288 | 104 | 35 | 20 | 81 |
| 63 | 2 | 16 | 158 400 217 | 8 | 0 | 0.888 | 114 | 288 | 104 | 35 | 24 | 85 |
| 63 | 2 ½ | 16 | 158 400 218 | 8 | 0 | 0.926 | 114 | 288 | 104 | 35 | 28 | 89 |
| 75 | 2 ½ | 16 | 158 400 219 | 7 | 0 | 1.621 | 135 | 360 | 133 | 41 | 28 | 101 |
| 75 | 3 | 16 | 158 400 220 | 6 | 0 | 1.738 | 135 | 360 | 133 | 41 | 30 | 104 |
| 90 | 3 | 16 | 158 400 221 | 2 | 0 | 2.647 | 161 | 413 | 150 | 44 | 30 | 116 |
| 110 | 4 | 16 | 158 400 222 | 2 | 0 | 4.022 | 185 | 484 | 175 | 53 | 36 | 138 |

PF 2 85 A07 001



90° Tee with threaded female off take

- with stainless steel reinforcement ring (AISI430)
- installation without disassembling
- suitable for PE and PEX pipes
- water PN16
- material: PP
- gasket: NBR quality for drinkable water
- female thread: ISO 7 (parallel)
- colour: blue-black

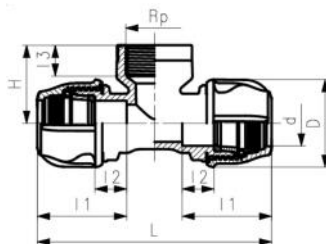

| d | Rp | PN | Code | SP | GP | Weight | D | L | I1 | I2 | I3 | H |
|------|--------|-------|-------------|----|-----|--------|------|------|------|------|------|------|
| (mm) | (inch) | (bar) | | | | (kg) | (mm) | (mm) | (mm) | (mm) | (mm) | (mm) |
| 20 | ½ | 16 | 158 400 177 | 1 | 100 | 0.079 | 45 | 134 | 54 | 19 | 15 | 40 |
| 20 | ¾ | 16 | 158 400 178 | 1 | 100 | 0.080 | 45 | 134 | 54 | 19 | 16 | 41 |
| 25 | ½ | 16 | 158 400 179 | 1 | 80 | 0.105 | 53 | 150 | 59 | 21 | 15 | 40 |
| 25 | ¾ | 16 | 158 400 180 | 1 | 80 | 0.117 | 53 | 150 | 59 | 21 | 16 | 44 |
| 25 | 1 | 16 | 158 400 181 | 1 | 75 | 0.125 | 53 | 150 | 59 | 21 | 20 | 49 |
| 32 | ½ | 16 | 158 400 182 | 1 | 50 | 0.172 | 64 | 173 | 66 | 23 | 15 | 42 |
| 32 | ¾ | 16 | 158 400 183 | 1 | 50 | 0.182 | 64 | 173 | 66 | 23 | 16 | 46 |
| 32 | 1 | 16 | 158 400 184 | 1 | 50 | 0.188 | 64 | 173 | 66 | 23 | 20 | 54 |
| 32 | 1 ¼ | 16 | 158 400 185 | 1 | 50 | 0.208 | 64 | 173 | 66 | 23 | 22 | 57 |
| 40 | ¾ | 16 | 158 400 186 | 35 | 0 | 0.283 | 75 | 203 | 76 | 26 | 16 | 49 |
| 40 | 1 | 16 | 158 400 187 | 35 | 0 | 0.295 | 75 | 203 | 76 | 26 | 20 | 57 |
| 40 | 1 ¼ | 16 | 158 400 188 | 35 | 0 | 0.310 | 75 | 203 | 76 | 26 | 22 | 62 |
| 40 | 1 ½ | 16 | 158 400 189 | 35 | 0 | 0.322 | 75 | 206 | 76 | 26 | 22 | 63 |
| 50 | 1 | 16 | 158 400 190 | 22 | 0 | 0.547 | 97 | 239 | 88 | 30 | 20 | 61 |
| 50 | 1 ¼ | 16 | 158 400 191 | 22 | 0 | 0.569 | 97 | 239 | 88 | 30 | 22 | 66 |
| 50 | 1 ½ | 16 | 158 400 192 | 22 | 0 | 0.585 | 97 | 171 | 88 | 30 | 22 | 70 |
| 50 | 2 | 16 | 158 400 193 | 18 | 0 | 0.613 | 97 | 239 | 88 | 30 | 26 | 75 |
| 63 | 1 ¼ | 16 | 158 400 194 | 10 | 0 | 0.882 | 114 | 288 | 104 | 35 | 22 | 73 |

table continued on the next page

PF 2 85 A07 001

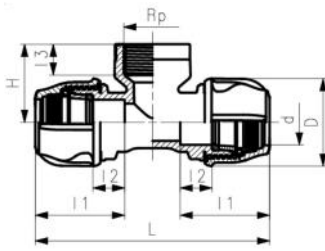

| d | Rp | PN | Code | SP | GP | Weight | D | L | l1 | l2 | l3 | H |
|------|--------|-------|--------------------|----|----|--------|------|------|------|------|------|------|
| (mm) | (inch) | (bar) | | | | (kg) | (mm) | (mm) | (mm) | (mm) | (mm) | (mm) |
| 63 | 1 ½ | 16 | 158 400 195 | 10 | 0 | 0.908 | 114 | 288 | 104 | 35 | 22 | 76 |
| 63 | 2 | 16 | 158 400 196 | 10 | 0 | 0.948 | 114 | 207 | 104 | 35 | 26 | 83 |
| 75 | 2 ½ | 16 | 158 400 197 | 6 | 0 | 1.749 | 135 | 360 | 133 | 41 | 31 | 101 |
| 90 | 3 | 10 | 158 400 198 | 3 | 0 | 2.620 | 161 | 413 | 150 | 44 | 34 | 116 |
| 110 | 4 | 10 | 158 400 199 | 2 | 0 | 4.162 | 185 | 484 | 175 | 53 | 40 | 135 |



90° Elbow

- installation without disassembling
- suitable for PE and PEX pipes
- water PN16
- material: PP
- gasket: NBR quality for drinkable water
- colour: blue-black

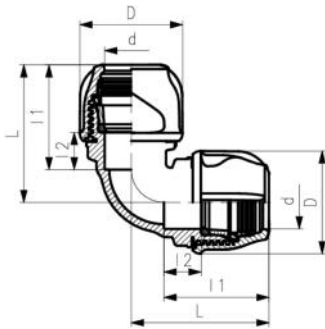

| d | PN | Code | PF | SP | GP | Weight | D | L | l1 | l2 |
|------|-------|--------------------|--------------|----|-----|--------|------|------|------|------|
| (mm) | (bar) | | | | | (kg) | (mm) | (mm) | (mm) | (mm) |
| 16 | 16 | 158 400 356 | 2 85 A07 020 | 1 | 50 | 0.066 | 44 | 113 | 46 | 19 |
| 20 | 16 | 158 400 070 | 2 85 A07 001 | 1 | 150 | 0.066 | 45 | 67 | 54 | 19 |
| 25 | 16 | 158 400 071 | 2 85 A07 001 | 1 | 100 | 0.105 | 53 | 75 | 59 | 21 |
| 32 | 16 | 158 400 072 | 2 85 A07 001 | 1 | 65 | 0.172 | 64 | 87 | 66 | 23 |
| 40 | 16 | 158 400 073 | 2 85 A07 001 | 30 | 0 | 0.265 | 75 | 102 | 76 | 26 |
| 50 | 16 | 158 400 074 | 2 85 A07 001 | 24 | 0 | 0.509 | 97 | 119 | 88 | 30 |
| 63 | 16 | 158 400 075 | 2 85 A07 001 | 10 | 0 | 0.821 | 114 | 144 | 104 | 35 |
| 75 | 16 | 158 400 076 | 2 85 A07 001 | 8 | 0 | 1.479 | 135 | 180 | 133 | 41 |
| 90 | 16 | 158 400 077 | 2 85 A07 001 | 3 | 0 | 2.435 | 161 | 207 | 150 | 44 |
| 110 | 16 | 158 400 078 | 2 85 A07 001 | 2 | 0 | 3.584 | 185 | 242 | 175 | 53 |



90° Elbow with threaded male off take

- installation without disassembling
- suitable for PE and PEX pipes
- water PN16
- material: PP
- gasket: NBR quality for drinkable water
- male thread: ISO 7 (conical)
- colour: blue-black

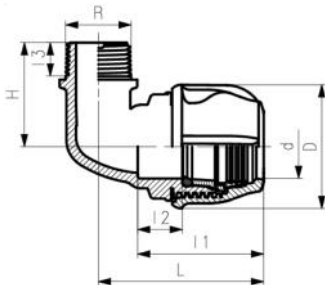

| d | R | PN | Code | PF | SP | GP | Weight |
|------|--------|-------|--------------------|--------------|----|-----|--------|
| (mm) | (inch) | (bar) | | | | | (kg) |
| 16 | ½ | 16 | 158 400 357 | 2 85 A07 020 | 1 | 60 | 0.047 |
| 20 | ½ | 16 | 158 400 047 | 2 85 A07 001 | 1 | 200 | 0.041 |
| 20 | ¾ | 16 | 158 400 048 | 2 85 A07 001 | 1 | 200 | 0.043 |
| 25 | ½ | 16 | 158 400 049 | 2 85 A07 001 | 1 | 150 | 0.062 |
| 25 | ¾ | 16 | 158 400 050 | 2 85 A07 001 | 1 | 150 | 0.062 |
| 25 | 1 | 16 | 158 400 051 | 2 85 A07 001 | 1 | 150 | 0.067 |
| 32 | ½ | 16 | 158 400 052 | 2 85 A07 001 | 1 | 120 | 0.100 |
| 32 | ¾ | 16 | 158 400 053 | 2 85 A07 001 | 1 | 115 | 0.098 |
| 32 | 1 | 16 | 158 400 054 | 2 85 A07 001 | 1 | 100 | 0.105 |
| 40 | 1 | 16 | 158 400 055 | 2 85 A07 001 | 70 | 0 | 0.159 |
| 40 | 1 ¼ | 16 | 158 400 056 | 2 85 A07 001 | 70 | 0 | 0.175 |
| 40 | 1 ½ | 16 | 158 400 057 | 2 85 A07 001 | 70 | 0 | 0.175 |
| 50 | 1 ¼ | 16 | 158 400 058 | 2 85 A07 001 | 45 | 0 | 0.301 |
| 50 | 1 ½ | 16 | 158 400 059 | 2 85 A07 001 | 45 | 0 | 0.316 |
| 63 | 1 ¼ | 16 | 158 400 060 | 2 85 A07 001 | 25 | 0 | 0.478 |
| 63 | 1 ½ | 16 | 158 400 061 | 2 85 A07 001 | 25 | 0 | 0.492 |
| 63 | 2 | 16 | 158 400 062 | 2 85 A07 001 | 20 | 0 | 0.513 |
| 63 | 2 ½ | 16 | 158 400 063 | 2 85 A07 001 | 15 | 0 | 0.534 |

table continued on the next page

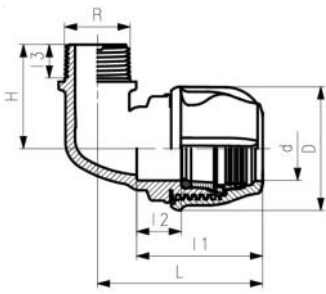

| d | R | PN | Code | PF | SP | GP | Weight |
|------|--------|-------|--------------------|--------------|----|----|--------|
| (mm) | (inch) | (bar) | | | | | (kg) |
| 75 | 2 ½ | 16 | 158 400 064 | 2 85 A07 001 | 12 | 0 | 0.932 |
| 75 | 3 | 16 | 158 400 065 | 2 85 A07 001 | 10 | 0 | 0.969 |
| 90 | 3 | 16 | 158 400 066 | 2 85 A07 001 | 7 | 0 | 1.421 |
| 90 | 4 | 16 | 158 400 067 | 2 85 A07 001 | 7 | 0 | 1.598 |
| 110 | 3 | 16 | 158 400 068 | 2 85 A07 001 | 4 | 0 | 2.168 |
| 110 | 4 | 16 | 158 400 069 | 2 85 A07 001 | 2 | 0 | 2.239 |

| d | R | D | L | l1 | l2 | l3 | H |
|------|--------|------|------|------|------|------|------|
| (mm) | (inch) | (mm) | (mm) | (mm) | (mm) | (mm) | (mm) |
| 16 | ½ | 46 | 91 | 46 | 19 | 14 | 41 |
| 20 | ½ | 45 | 67 | 54 | 19 | 14 | 41 |
| 20 | ¾ | 45 | 67 | 54 | 19 | 15 | 42 |
| 25 | ½ | 53 | 75 | 59 | 21 | 14 | 44 |
| 25 | ¾ | 53 | 75 | 59 | 21 | 15 | 46 |
| 25 | 1 | 53 | 75 | 59 | 21 | 17 | 48 |
| 32 | ½ | 64 | 87 | 66 | 23 | 14 | 49 |
| 32 | ¾ | 64 | 87 | 66 | 23 | 15 | 51 |
| 32 | 1 | 64 | 87 | 66 | 23 | 17 | 53 |
| 40 | 1 | 75 | 102 | 76 | 26 | 17 | 60 |
| 40 | 1 ¼ | 75 | 102 | 75 | 26 | 20 | 62 |
| 40 | 1 ½ | 75 | 102 | 75 | 26 | 20 | 62 |
| 50 | 1 ¼ | 97 | 119 | 88 | 30 | 20 | 70 |
| 50 | 1 ½ | 97 | 117 | 88 | 30 | 20 | 70 |
| 63 | 1 ¼ | 114 | 144 | 104 | 35 | 20 | 81 |
| 63 | 1 ½ | 114 | 144 | 104 | 35 | 20 | 81 |
| 63 | 2 | 114 | 144 | 104 | 35 | 24 | 85 |
| 63 | 2 ½ | 114 | 144 | 104 | 35 | 28 | 89 |
| 75 | 2 ½ | 135 | 180 | 133 | 41 | 28 | 101 |
| 75 | 3 | 135 | 180 | 133 | 41 | 30 | 104 |
| 90 | 3 | 161 | 207 | 150 | 44 | 30 | 116 |
| 90 | 4 | 161 | 207 | 150 | 44 | 36 | 122 |
| 110 | 3 | 185 | 242 | 175 | 53 | 30 | 131 |
| 110 | 4 | 185 | 242 | 175 | 53 | 36 | 138 |

PF 2 85 A07 001



90° Elbow with threaded female off take

- with stainless steel reinforcement ring (**AISI430**)
- gasket: NBR quality for drinkable water
- installation without disassembling
- suitable for PE and PEX pipes
- water PN16
- material: PP
- female thread: ISO 7 (parallel)
- colour: blue-black

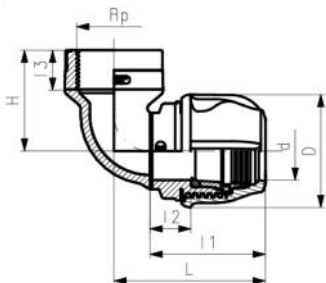

| d | Rp | PN | Code | SP | GP | Weight | D | L | l1 | l2 | l3 | H |
|------|--------|-------|--------------------|----|-----|--------|------|------|------|------|------|------|
| (mm) | (inch) | (bar) | | | | (kg) | (mm) | (mm) | (mm) | (mm) | (mm) | (mm) |
| 20 | ½ | 16 | 158 400 022 | 1 | 180 | 0.047 | 45 | 67 | 54 | 19 | 15 | 40 |
| 20 | ¾ | 16 | 158 400 023 | 1 | 180 | 0.049 | 45 | 67 | 54 | 19 | 16 | 40 |
| 25 | ½ | 16 | 158 400 024 | 1 | 150 | 0.060 | 53 | 75 | 59 | 21 | 15 | 40 |
| 25 | ¾ | 16 | 158 400 025 | 1 | 150 | 0.060 | 53 | 75 | 59 | 21 | 16 | 44 |
| 25 | 1 | 16 | 158 400 026 | 1 | 125 | 0.078 | 53 | 75 | 59 | 21 | 16 | 44 |
| 32 | ½ | 16 | 158 400 027 | 1 | 110 | 0.089 | 64 | 87 | 66 | 23 | 15 | 43 |
| 32 | ¾ | 16 | 158 400 028 | 1 | 110 | 0.106 | 64 | 87 | 66 | 23 | 16 | 46 |
| 32 | 1 | 16 | 158 400 029 | 1 | 100 | 0.117 | 64 | 87 | 66 | 23 | 20 | 54 |
| 32 | 1 ¼ | 16 | 158 400 030 | 1 | 90 | 0.127 | 64 | 87 | 66 | 23 | 22 | 57 |
| 40 | ¾ | 16 | 158 400 031 | 70 | 0 | 0.159 | 75 | 102 | 76 | 26 | 16 | 49 |
| 40 | 1 | 16 | 158 400 032 | 70 | 0 | 0.178 | 75 | 102 | 76 | 26 | 20 | 57 |
| 40 | 1 ¼ | 16 | 158 400 033 | 70 | 0 | 0.182 | 75 | 102 | 76 | 26 | 22 | 62 |
| 40 | 1 ½ | 16 | 158 400 034 | 50 | 0 | 0.198 | 75 | 102 | 76 | 26 | 22 | 63 |
| 50 | 1 | 16 | 158 400 035 | 30 | 0 | 0.281 | 97 | 119 | 88 | 30 | 20 | 61 |
| 50 | 1 ¼ | 16 | 158 400 036 | 30 | 0 | 0.320 | 97 | 119 | 88 | 30 | 22 | 66 |

table continued on the next page

PF 2 85 A07 001

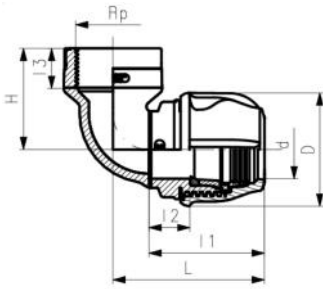

| d (mm) | Rp (inch) | PN (bar) | Code | SP | GP | Weight (kg) | D (mm) | L (mm) | l1 (mm) | l2 (mm) | l3 (mm) | H (mm) |
|-----------|--------------|-------------|--------------------|----|----|----------------|-----------|-----------|------------|------------|------------|-----------|
| 50 | 1 ½ | 16 | 158 400 037 | 30 | 0 | 0.335 | 97 | 119 | 88 | 30 | 22 | 70 |
| 50 | 2 | 16 | 158 400 038 | 30 | 0 | 0.348 | 97 | 119 | 88 | 30 | 26 | 75 |
| 63 | 1 ¼ | 16 | 158 400 039 | 15 | 0 | 0.502 | 114 | 144 | 104 | 35 | 22 | 73 |
| 63 | 1 ½ | 16 | 158 400 040 | 15 | 0 | 0.513 | 114 | 144 | 104 | 35 | 22 | 76 |
| 63 | 2 | 16 | 158 400 041 | 15 | 0 | 0.564 | 114 | 144 | 104 | 35 | 26 | 83 |
| 75 | 2 | 16 | 158 400 042 | 12 | 0 | 0.949 | 135 | 180 | 133 | 41 | 26 | 91 |
| 75 | 2 ½ | 16 | 158 400 043 | 12 | 0 | 0.988 | 135 | 180 | 133 | 41 | 31 | 101 |
| 75 | 3 | 10 | 158 400 044 | 10 | 0 | 1.105 | 135 | 180 | 133 | 41 | 34 | 108 |
| 90 | 3 | 10 | 158 400 045 | 6 | 0 | 1.607 | 161 | 207 | 150 | 44 | 34 | 116 |
| 110 | 4 | 10 | 158 400 046 | 3 | 0 | 2.482 | 185 | 242 | 175 | 53 | 40 | 135 |

PF 2 85 A07 001

45° Elbow



- installation without disassembling
- suitable for PE and PEX pipes
- water PN16
- material: PP
- gasket: NBR quality for drinkable water
- colour: blue-black

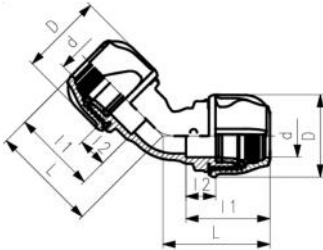

| d (mm) | PN (bar) | Code | SP | GP | Weight (kg) | D (mm) | L (mm) | l1 (mm) | l2 (mm) |
|-----------|-------------|--------------------|----|-----|----------------|-----------|-----------|------------|------------|
| 20 | 16 | 158 400 016 | 1 | 150 | 0.065 | 45 | 65 | 54 | 19 |
| 25 | 16 | 158 400 017 | 1 | 90 | 0.101 | 53 | 82 | 59 | 21 |
| 32 | 16 | 158 400 018 | 1 | 60 | 0.164 | 64 | 84 | 66 | 23 |
| 40 | 16 | 158 400 019 | 30 | 0 | 0.264 | 75 | 96 | 76 | 26 |
| 50 | 16 | 158 400 020 | 20 | 0 | 0.511 | 97 | 113 | 88 | 30 |
| 63 | 16 | 158 400 021 | 10 | 0 | 0.819 | 114 | 133 | 104 | 35 |

PF 2 85 A07 001

45° Elbow with threaded male off take



- installation without disassembling
- suitable for PE and PEX pipes
- water PN16
- material: PP
- gasket: NBR quality for drinkable water
- male thread: ISO 7 (conical)
- colour: blue-black

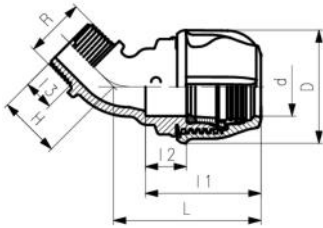

| d (mm) | R (inch) | PN (bar) | Code | SP | GP | Weight (kg) | D (mm) | L (mm) | l1 (mm) | l2 (mm) | l3 (mm) | H (mm) |
|-----------|-------------|-------------|--------------------|----|-----|----------------|-----------|-----------|------------|------------|------------|-----------|
| 20 | ¾ | 16 | 158 400 010 | 1 | 150 | 0.037 | 45 | 65 | 54 | 19 | 14 | 26 |
| 25 | ¾ | 16 | 158 400 011 | 1 | 150 | 0.052 | 53 | 75 | 59 | 21 | 15 | 30 |
| 32 | 1 | 16 | 158 400 012 | 1 | 100 | 0.096 | 64 | 84 | 66 | 23 | 17 | 35 |
| 40 | 1 ¼ | 16 | 158 400 013 | 50 | 0 | 0.157 | 75 | 96 | 76 | 26 | 20 | 41 |
| 50 | 1 ½ | 16 | 158 400 014 | 35 | 0 | 0.269 | 97 | 113 | 88 | 30 | 20 | 44 |
| 63 | 2 | 16 | 158 400 015 | 20 | 0 | 0.482 | 114 | 133 | 104 | 35 | 24 | 53 |

PF 2 85 A07 001

Flanged joint with metal flange

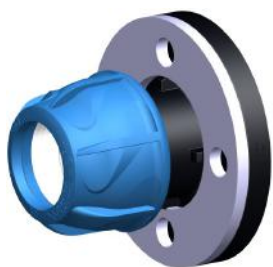

- installation without disassembling
- suitable for PE and PEX pipes
- water PN16
- material: PP
- gasket: NBR quality for drinkable water
- flange: steel
- colour: blue-black

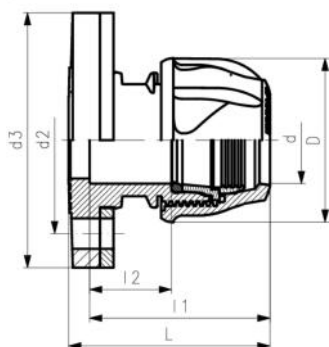

| d | DN | DN | PN | Code | SP | Weight | D | d2 | d3 | L | l1 | l2 |
|------|--------|------|-------|--------------------|----|--------|------|------|------|------|------|------|
| (mm) | (inch) | (mm) | (bar) | | | (kg) | (mm) | (mm) | (mm) | (mm) | (mm) | (mm) |
| 50 | 1 ½ | 40 | 16 | 158 400 114 | 16 | 1.131 | 97 | 110 | 150 | 118 | 88 | 30 |
| 50 | 2 | 50 | 16 | 158 400 115 | 16 | 1.168 | 97 | 125 | 160 | 119 | 88 | 30 |
| 63 | 2 | 50 | 16 | 158 400 116 | 12 | 1.277 | 114 | 125 | 160 | 13 | 104 | 35 |
| 63 | 2 ½ | 65 | 16 | 158 400 117 | 12 | 1.621 | 114 | 145 | 187 | 137 | 104 | 35 |
| 75 | 2 ½ | 65 | 16 | 158 400 118 | 8 | 1.932 | 135 | 145 | 187 | 170 | 133 | 41 |
| 75 | 3 | 80 | 16 | 158 400 119 | 6 | 2.131 | 135 | 160 | 205 | 168 | 133 | 41 |
| 90 | 3 | 80 | 16 | 158 400 120 | 6 | 2.561 | 161 | 160 | 205 | 192 | 150 | 44 |
| 90 | 4 | 100 | 16 | 158 400 121 | 6 | 2.892 | 161 | 180 | 220 | 195 | 150 | 44 |
| 110 | 4 | 100 | 16 | 158 400 122 | 6 | 3.133 | 185 | 180 | 220 | 223 | 175 | 53 |

End cap



- installation without disassembling
- suitable for PE and PEX pipes
- water PN16
- material: PP
- gasket: NBR quality for drinkable water
- colour: blue-black

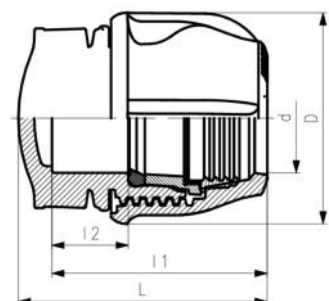

| d | PN | Code | PF | SP | GP | Weight | D | L | l1 | l2 |
|------|-------|--------------------|--------------|-----|-----|--------|------|------|------|------|
| (mm) | (bar) | | | | | (kg) | (mm) | (mm) | (mm) | (mm) |
| 16 | 16 | 158 400 353 | 2 85 A07 020 | 1 | 80 | 0.036 | 45 | 60 | 46 | 19 |
| 20 | 16 | 158 400 079 | 2 85 A07 001 | 1 | 250 | 0.036 | 45 | 60 | 54 | 19 |
| 25 | 16 | 158 400 080 | 2 85 A07 001 | 1 | 180 | 0.054 | 53 | 67 | 59 | 21 |
| 32 | 16 | 158 400 081 | 2 85 A07 001 | 1 | 130 | 0.085 | 64 | 76 | 66 | 23 |
| 40 | 16 | 158 400 082 | 2 85 A07 001 | 100 | 0 | 0.136 | 75 | 89 | 76 | 26 |
| 50 | 16 | 158 400 083 | 2 85 A07 001 | 55 | 0 | 0.266 | 97 | 104 | 88 | 30 |
| 63 | 16 | 158 400 084 | 2 85 A07 001 | 30 | 0 | 0.422 | 114 | 124 | 104 | 35 |
| 75 | 16 | 158 400 085 | 2 85 A07 001 | 18 | 0 | 0.777 | 135 | 155 | 133 | 41 |
| 90 | 16 | 158 400 086 | 2 85 A07 001 | 8 | 0 | 1.230 | 161 | 178 | 150 | 44 |
| 110 | 16 | 158 400 087 | 2 85 A07 001 | 6 | 0 | 1.882 | 185 | 209 | 175 | 53 |

PF 2 85 A07 010

Metal transition coupling male



- installation without disassembling
- suitable for PE and PEX pipes
- water PN16
- material: PP / brass
- gasket: NBR quality for drinkable water
- male thread: ISO 7 (conical) brass
- Metal insert with hexagon starting from R 1¼
- colour: blue-black

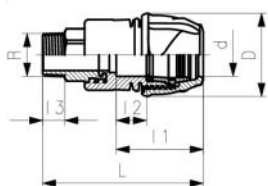

| d | R | Code | SP | Weight | D | L | l3 | l1 | l2 |
|------|--------|--------------------|----|--------|------|-------|------|------|------|
| (mm) | (inch) | | | (kg) | (mm) | (mm) | (mm) | (mm) | (mm) |
| 20 | ½ | 158 400 281 | 50 | 0.112 | 45 | 100.6 | 14.7 | 54 | 19 |
| 25 | ¾ | 158 400 282 | 25 | 0.165 | 53 | 108.9 | 15.0 | 59 | 21 |
| 32 | ¾ | 158 400 283 | 18 | 0.200 | 64 | 117.2 | 15.0 | 66 | 23 |
| 32 | 1 | 158 400 284 | 18 | 0.269 | 64 | 122.7 | 17.0 | 66 | 23 |
| 32 | 1 ¼ | 158 400 285 | 14 | 0.527 | 64 | 136.1 | 19.0 | 66 | 23 |

table continued on the next page

PF 2 85 A07 010

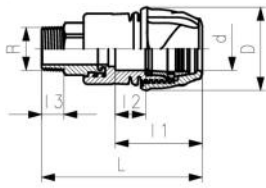

| d (mm) | R (inch) | Code | SP | Weight (kg) | D (mm) | L (mm) | I3 (mm) | I1 (mm) | I2 (mm) |
|-----------|-------------|-------------|----|----------------|-----------|-----------|------------|------------|------------|
| 32 | 1 ½ | 158 400 286 | 12 | 0.555 | 64 | 139.4 | 20.0 | 66 | 23 |
| 40 | 1 | 158 400 287 | 12 | 0.342 | 75 | 138.2 | 17.0 | 76 | 26 |
| 40 | 1 ¼ | 158 400 288 | 12 | 0.547 | 75 | 143.9 | 19.0 | 76 | 26 |
| 40 | 1 ½ | 158 400 289 | 12 | 0.576 | 75 | 147.2 | 20.0 | 76 | 26 |
| 40 | 2 | 158 400 290 | 6 | 0.808 | 75 | 160.8 | 25.0 | 76 | 26 |
| 50 | 1 ¼ | 158 400 291 | 6 | 0.706 | 97 | 157.1 | 19.0 | 88 | 30 |
| 50 | 1 ½ | 158 400 292 | 6 | 0.733 | 97 | 160.4 | 20.0 | 88 | 30 |
| 63 | 1 ½ | 158 400 293 | 3 | 0.988 | 114 | 180.5 | 20.0 | 104 | 35 |
| 63 | 2 | 158 400 294 | 3 | 1.154 | 114 | 190.5 | 25.0 | 104 | 35 |

PF 2 85 A07 010

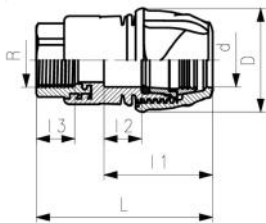

Metal transition coupling female

- installation without disassembling
- suitable for PE and PEX pipes
- water PN16
- material: PP / brass
- gasket: NBR quality for drinkable water
- female thread: ISO 7 (parallel) brass
- Metal insert with hexagon starting from Rp 1 ¼
- colour: blue-black

| d (mm) | Rp (inch) | Code | SP | Weight (kg) | D (mm) | L (mm) | I3 (mm) | I1 (mm) | I2 (mm) |
|-----------|--------------|-------------|----|----------------|-----------|-----------|------------|------------|------------|
| 20 | ½ | 158 400 295 | 50 | 0.093 | 45 | 87.1 | 54 | 19 | 13.2 |
| 25 | ¾ | 158 400 296 | 32 | 0.131 | 53 | 97.9 | 59 | 21 | 21.0 |
| 32 | 1 | 158 400 297 | 18 | 0.270 | 64 | 107.7 | 66 | 23 | 23.5 |
| 40 | 1 ¼ | 158 400 301 | 10 | 0.445 | 75 | 127.2 | 76 | 26 | 22.0 |
| 50 | 1 ½ | 158 400 302 | 6 | 0.619 | 97 | 141.9 | 88 | 30 | 22.0 |
| 63 | 2 | 158 400 303 | 2 | 0.988 | 114 | 165.5 | 104 | 85 | 25.0 |

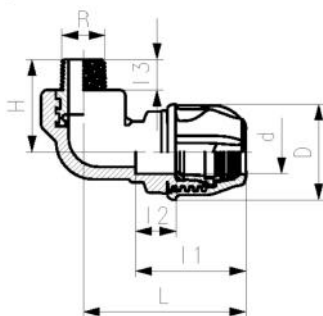

Metal transition 90° elbow male

- installation without disassembling
- suitable for PE and PEX pipes
- water PN16
- material: PP / brass
- gasket: NBR quality for drinkable water
- male thread: ISO 7 (conical) brass
- colour: blue-black

| d (mm) | Rp (inch) | Code | GP | Weight (kg) | D (mm) | L (mm) | I1 (mm) | I2 (mm) | I3 (mm) | H (mm) |
|-----------|--------------|-------------|----|----------------|-----------|-----------|------------|------------|------------|-----------|
| 20 | ½ | 158 400 340 | 25 | 0.126 | 45 | 65 | 55 | 15 | 15 | 45 |
| 25 | ¾ | 158 400 341 | 13 | 0.206 | 53 | 75 | 60 | 18 | 15 | 60 |
| 32 | 1 | 158 400 342 | 8 | 0.360 | 64 | 100 | 70 | 25 | 17 | 70 |

PF 2 85 A07 001

Metal tightening wrench for iJOINT fittings

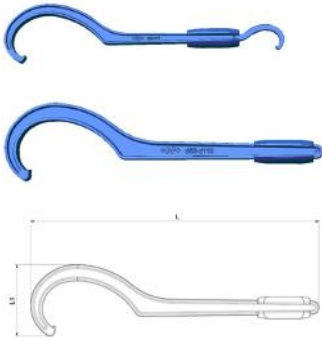

| d-d (mm) | Code | SP | GP | Weight (kg) | L (mm) | L1 (mm) |
|-------------|--------------------|----|----|----------------|-----------|------------|
| 20 - 75 | 158 400 998 | 2 | 0 | 0.656 | 540 | 115 |
| 63 - 110 | 158 400 999 | 2 | 0 | 1.642 | 660 | 165 |

PF 2 85 A07 001

Reduction KIT

- water PN16
- material: PP
- gasket: NBR quality for drinkable water
- non-compliance with iJOINT repairing coupling



| | d-d (mm) | Code | SP | GP | Weight (kg) |
|---|-------------|--------------------|----|----|----------------|
| A | 20 - 16 | 158 400 300 | 1 | 10 | 0.021 |
| B | 25 - 20 | 158 400 304 | 1 | 10 | 0.021 |
| B | 32 - 20 | 158 400 305 | 1 | 10 | 0.040 |
| B | 32 - 25 | 158 400 306 | 1 | 10 | 0.032 |
| B | 40 - 20 | 158 400 307 | 1 | 8 | 0.070 |
| B | 40 - 25 | 158 400 308 | 1 | 8 | 0.075 |
| B | 40 - 32 | 158 400 309 | 1 | 8 | 0.065 |
| B | 50 - 25 | 158 400 310 | 1 | 6 | 0.101 |
| B | 50 - 32 | 158 400 311 | 1 | 6 | 0.112 |
| B | 50 - 40 | 158 400 312 | 1 | 6 | 0.104 |
| B | 63 - 25 | 158 400 313 | 1 | 5 | 0.178 |
| B | 63 - 32 | 158 400 314 | 1 | 5 | 0.195 |
| B | 63 - 40 | 158 400 315 | 1 | 5 | 0.195 |
| B | 63 - 50 | 158 400 316 | 1 | 5 | 0.192 |

PF 2 85 A07 001

PVC KIT

- suitable for PVC-U and ABS pipes
- with PVC-U pipe: maximum operating pressure PN16
- with ABS pipe: maximum operating pressure PN10
- material: POM and brass
- non-compliance with iJOINT repairing coupling



| d (mm) | Code | SP | GP | Weight (kg) |
|-----------|--------------------|----|----|----------------|
| 20 | 158 400 317 | 1 | 25 | 0.008 |
| 25 | 158 400 318 | 1 | 25 | 0.012 |
| 32 | 158 400 319 | 1 | 25 | 0.018 |
| 40 | 158 400 320 | 1 | 25 | 0.025 |
| 50 | 158 400 321 | 1 | 25 | 0.038 |
| 63 | 158 400 322 | 1 | 25 | 0.048 |

iJOINT Spare Parts

PF 2 85 A07 001



Nut

| d (mm) | Code | Weight (kg) |
|-----------|--------------------|----------------|
| 20 | 158 400 266 | 0.015 |
| 25 | 158 400 267 | 0.022 |
| 32 | 158 400 268 | 0.036 |
| 40 | 158 400 269 | 0.055 |
| 50 | 158 400 270 | 0.095 |
| 63 | 158 400 271 | 0.169 |
| 75 | 158 400 272 | 0.310 |
| 90 | 158 400 273 | 0.469 |
| 110 | 158 400 274 | 0.760 |

PF 2 85 A07 001



Gasket

| | d (mm) | Code | Weight (kg) |
|---|-----------|--------------------|----------------|
| A | 20 | 158 400 254 | 0.004 |
| A | 25 | 158 400 255 | 0.002 |
| A | 32 | 158 400 256 | 0.003 |
| A | 40 | 158 400 257 | 0.005 |
| A | 50 | 158 400 258 | 0.008 |
| A | 63 | 158 400 259 | 0.014 |
| B | 75 | 158 400 260 | 0.019 |
| B | 90 | 158 400 261 | 0.026 |
| B | 110 | 158 400 262 | 0.035 |

PF 2 85 A07 001



Repairing coupling gasket

| d (mm) | Code | Weight (kg) |
|-----------|--------------------|----------------|
| 20 | 158 400 275 | 0.002 |
| 25 | 158 400 276 | 0.002 |
| 32 | 158 400 277 | 0.003 |
| 40 | 158 400 278 | 0.004 |
| 50 | 158 400 279 | 0.008 |
| 63 | 158 400 280 | 0.013 |

PF 2 85 A07 001

Split ring



| | d (mm) | Code | Weight (kg) |
|---|------------------|--------------------|-----------------------|
| A | 20 | 158 400 244 | 0.004 |
| A | 25 | 158 400 245 | 0.006 |
| A | 32 | 158 400 246 | 0.010 |
| A | 40 | 158 400 247 | 0.015 |
| A | 50 | 158 400 248 | 0.027 |
| A | 63 | 158 400 249 | 0.025 |
| B | 75 | 158 400 250 | 0.052 |
| B | 90 | 158 400 251 | 0.075 |
| B | 110 | 158 400 252 | 0.116 |

PF 2 85 A07 001

Thrust ring



| | d (mm) | Code | Weight (kg) |
|---|------------------|--------------------|-----------------------|
| A | 20 | 158 400 323 | 0.003 |
| A | 25 | 158 400 324 | 0.004 |
| A | 32 | 158 400 325 | 0.006 |
| A | 40 | 158 400 326 | 0.009 |
| A | 63 | 158 400 328 | 0.029 |
| A | 50 | 158 400 327 | 0.017 |
| B | 75 | 158 400 263 | 0.054 |
| B | 90 | 158 400 264 | 0.077 |
| B | 110 | 158 400 265 | 0.113 |

Universal Fittings

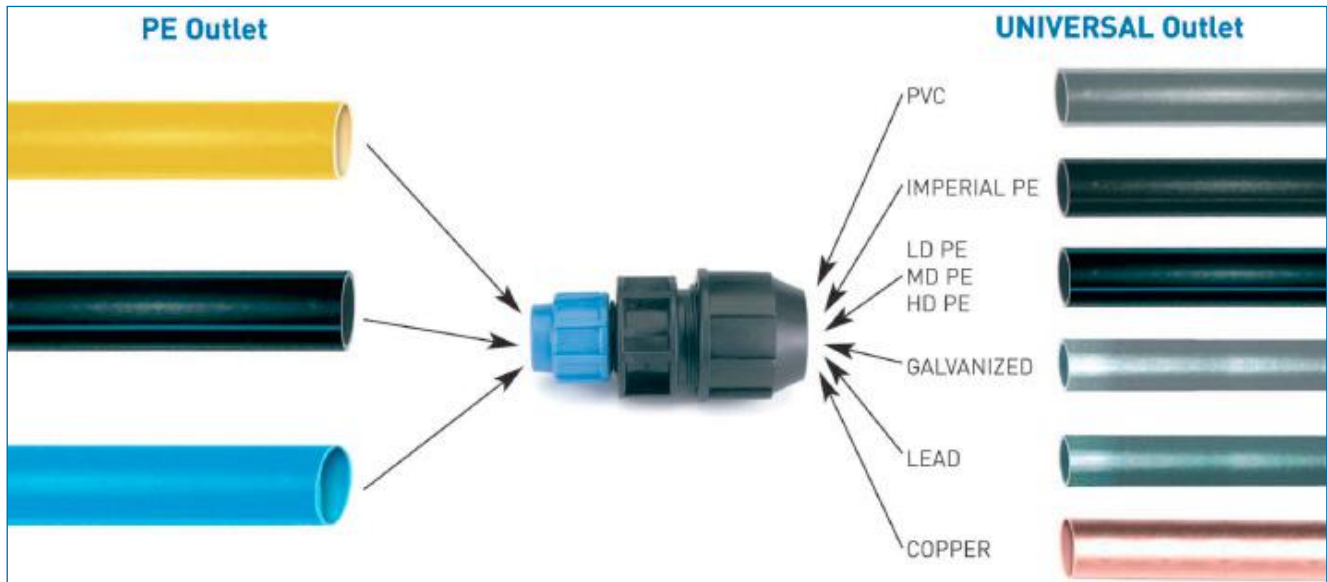

1. Cut the pipe at a 90-degree angle (square cut). When possible, it is recommended to bevel the edges of the cut in order to make the insertion easier.



2. Slacken the ring nut without removing from the body.



3. Insert the pipe end without tightening the nut. Push the fitting until the pipe reaches the stop.

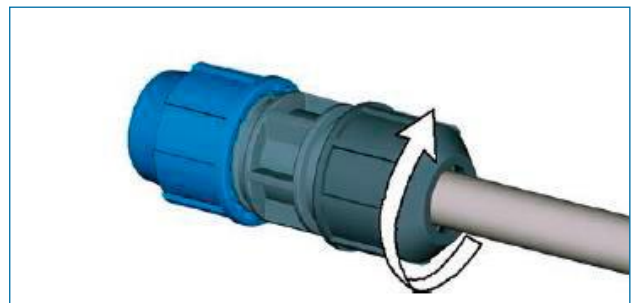

4. Hand tighten the nut and then tighten further with a proper tool. Do not screw the Universal nut without pipe.

In order to disassemble the Universal nut, keep in mind that the Universal split ring may require a manual opening of the ends to unvail the steel grippers from the pipe.

Attention: universal fittings components are NOT compatible with iJOINT standard fitting range

PF 2 85 A07 001

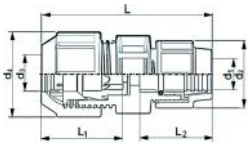

Coupling

- black offtake: suitable for Metric and Imperial PE, PEX, PVC, ABS, galvanized, lead, copper pipes
- blue offtake: suitable for PE pipe
- water PN10
- material: PP
- gasket: EPDM quality for drinkable water
- non-compliance with iJOINT
- colour: blue-black

| PE outlet (mm) | Universal outlet (mm) | PN (bar) | Code | SP | GP | Weight (kg) |
|-------------------|--------------------------|-------------|--------------------|----|-----|----------------|
| 20 | 15 - 21 | 10 | 158 001 713 | 1 | 140 | 0.119 |
| 20 | 21 - 27 | 10 | 158 001 714 | 1 | 100 | 0.164 |
| 20 | 27 - 35 | 10 | 158 001 715 | 1 | 70 | 0.269 |
| 25 | 15 - 21 | 10 | 158 001 716 | 1 | 100 | 0.145 |
| 25 | 21 - 27 | 10 | 158 001 717 | 1 | 90 | 0.189 |
| 25 | 27 - 35 | 10 | 158 001 718 | 1 | 60 | 0.239 |
| 32 | 21 - 27 | 10 | 158 001 719 | 1 | 70 | 0.206 |
| 32 | 27 - 35 | 10 | 158 001 720 | 1 | 50 | 0.312 |

| PE outlet (mm) | Universal outlet (mm) | PN (bar) | d1 (mm) | d2 (mm) | d3 (mm) | d4 (mm) | L (mm) | L1 (mm) | L2 (mm) |
|-------------------|--------------------------|-------------|------------|------------|------------|------------|-----------|------------|------------|
| 20 | 15 - 21 | 10 | 20 | 47 | 15 - 21 | 55 | 119 | 55 | 55 |
| 20 | 21 - 27 | 10 | 20 | 47 | 21 - 27 | 65 | 127 | 70 | 55 |
| 20 | 27 - 35 | 10 | 20 | 47 | 27 - 35 | 80 | 151 | 88 | 55 |
| 25 | 15 - 21 | 10 | 25 | 57 | 15 - 21 | 55 | 128 | 55 | 55 |
| 25 | 21 - 27 | 10 | 25 | 57 | 21 - 27 | 65 | 136 | 70 | 55 |
| 25 | 27 - 35 | 10 | 25 | 57 | 27 - 35 | 80 | 162 | 88 | 55 |
| 32 | 21 - 27 | 10 | 32 | 66 | 21 - 27 | 65 | 159 | 70 | 75 |
| 32 | 27 - 35 | 10 | 32 | 66 | 27 - 35 | 80 | 174 | 88 | 75 |

PF 2 85 A07 001

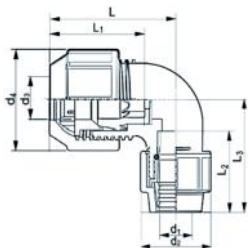

90° Elbow

- black offtake: suitable for Metric and Imperial PE, PEX, PVC, ABS, galvanized, lead, copper pipes
- blue offtake: suitable for PE pipe
- water PN10
- material: PP
- gasket: EPDM quality for drinkable water
- non-compliance with iJOINT
- colour: blue-black

| PE outlet (mm) | Universal outlet (mm) | PN (bar) | Code | SP | GP | Weight (kg) |
|-------------------|--------------------------|-------------|--------------------|----|-----|----------------|
| 25 | 15 - 21 | 10 | 158 001 721 | 1 | 100 | 0.146 |
| 25 | 21 - 27 | 10 | 158 001 722 | 1 | 90 | 0.201 |

| PE outlet (mm) | Universal outlet (mm) | PN (bar) | d1 (mm) | d2 (mm) | d3 (mm) | d4 (mm) | L (mm) | L1 (mm) | L2 (mm) | L3 (mm) |
|-------------------|--------------------------|-------------|------------|------------|------------|------------|-----------|------------|------------|------------|
| 25 | 15 - 21 | 10 | 25 | 57 | 15 - 21 | 55 | 69 | 55 | 65 | 74 |
| 25 | 21 - 27 | 10 | 25 | 57 | 21 - 27 | 65 | 76 | 70 | 70 | 74 |

Plastic Wall plate Elbows

PF 2 85 A07 001



Plastic Wall plate Elbow

- gasket: EPDM quality for drinkable water
- suitable for PE and PEX-a pipes
- water PN16
- female thread: ISO 7 (parallel)

| d | Rp | PN | Code | SP | GP | Weight | L | L1 | L2 | d1 | d2 | H |
|------|--------|-------|--------------------|----|-----|--------|------|------|------|------|------|------|
| (mm) | (inch) | (bar) | | | | (kg) | (mm) | (mm) | (mm) | (mm) | (mm) | (mm) |
| 20 | ½ | 16 | 158 001 919 | 10 | 250 | 0.053 | 62 | 16 | 51 | 22 | 45 | 52 |
| 25 | ¾ | 16 | 158 001 920 | 5 | 120 | 0.098 | 80 | 16 | 63 | 28 | 56 | 66 |

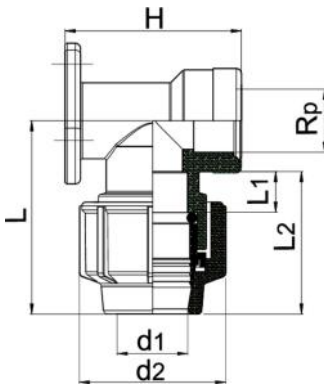

iJOINT Tapping Saddles

iJoint tapping saddles can be used to drill the pipe line under pressure, when extending or replacing distribution networks is required. The complete range of iJOINT tapping saddles from 63 up to 160 mm can be installed at 16 bar working pressure even in wet site conditions.



+ Technical Specification

Pressure range

MOP of 16 bar for the complete range

Temperature range

-10 °C to +45 °C

Materials

Body

UV stabilized polypropylene (PP)

Nut and sealing cup

UV stabilized polypropylene (PP)

Cutter

brass

Clamp ring

Poyacetal (POM)

Gaskets

Food-safe NBR rubber suitable for potable water

Bolts and nuts

stainless steel

Standards

For PE pipes:

DIN EN 12201; ISO 11922-1; DIN 8074; EN 12201-1/2; AS/NZS 4130; BS 6572; BS 6730; ISO 4427; UNI 7990;

ISO 12162

For PVC pipes:

UNI EN 1452-1/2; DIN 8062; ISO 4422-1/2

Threads

DIN EN 10226 (ISO 7-1); BS 21; AS 1722.1

Test Standards

AS/NZS 4129

ISO 13460

PF 2 85 788 003

684C - Tapping Saddle for PE and PVC pipes with compression fitting offtake, flat gasket and stainless steel bolts and nuts



- water PN16
- suitable for PE, PEX-a and PVC pipes
- material: PP
- cutter: brass
- gasket: NBR (saddle: O-ring with flat lip; offtake: double lip; sealing cup: O-ring)
- bolts and nuts : stainless steel
- colour: blue-black
- Key kit type (L=little; M=medium; B=big)
- B= N° of bolts
- M= bolt type
- Further offtake sizes obtainable with iJOINT reduction kit

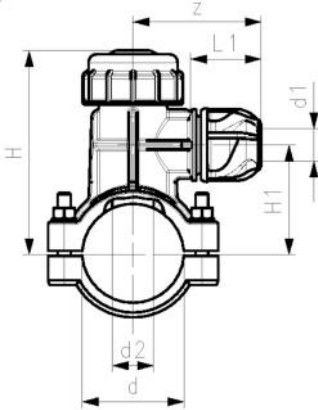

| d (mm) | d1 (mm) | PN (bar) | B | M | Key Kit type | Code | SP | GP | Weight (kg) |
|-----------|------------|-------------|---|---------|--------------|--------------------|----|----|----------------|
| 63 | 32 | 16 | 4 | M8x50 | L | 158 400 702 | 1 | 8 | 0.536 |
| 75 | 40 | 16 | 4 | M8x70 | M | 158 400 705 | 1 | 5 | 0.795 |
| 90 | 40 | 16 | 4 | M8x70 | M | 158 400 708 | 1 | 5 | 0.853 |
| 110 | 25 | 16 | 6 | M8x70 | M | 158 400 710 | 1 | 2 | 1.016 |
| 110 | 32 | 16 | 6 | M8x70 | M | 158 400 711 | 1 | 2 | 1.042 |
| 110 | 63 | 16 | 6 | M8x70 | B | 158 400 716 | 1 | 1 | 1.763 |
| 160 | 32 | 16 | 6 | M10x110 | B | 158 400 720 | 1 | 0 | 2.214 |
| 160 | 63 | 16 | 6 | M10x110 | B | 158 400 723 | 1 | | 2.673 |

| d (mm) | d1 (mm) | d2 (mm) | H (mm) | H1 (mm) | L (mm) | L1 (mm) | z (mm) |
|-----------|------------|------------|-----------|------------|-----------|------------|-----------|
| 63 | 32 | 26 | 125 | 65 | 90 | 63 | 100 |
| 75 | 40 | 33 | 142 | 75 | 90 | 74 | 120 |
| 90 | 40 | 33 | 152 | 85 | 100 | 74 | 120 |
| 110 | 25 | 33 | 190 | 108 | 130 | 60 | 100 |
| 110 | 32 | 33 | 190 | 108 | 130 | 77 | 118 |
| 110 | 63 | 40 | 205 | 118 | 130 | 125 | 180 |
| 160 | 32 | 40 | 235 | 140 | 160 | 76 | 120 |
| 160 | 63 | 40 | 250 | 155 | 160 | 128 | 180 |

PF 2 85 788 003

Key kit for Tapping Saddle



- Essential for Tapping Saddle

| Dim. | Code | SP | Weight (kg) |
|------------|--------------------|----|----------------|
| L (little) | 158 001 777 | 4 | 0.552 |
| M (medium) | 158 001 778 | 4 | 0.710 |
| B (big) | 158 001 779 | 4 | 0.896 |

Clamp Saddles

A complete range of clamp saddles up to d 315 mm for water market. The blue saddle with flat gasket in NBR provides outstanding hydraulic performance even in case of out of roundness, scratched or undersized pipes. The flat gasket guarantees a perfect adherence to the pipe, increasing the contact surface, granting also high resistance in case of vacuum and/or suction.



+ Technical Specification

Table su Pressure range

MOP of 16 bar from 20 mm up to 160 x 2"
MOP of 10 bar from 160 x 3" up to 315 mm

Temperature range

-10 °C to + 45°C

Materials

Body
polypropylene copolymer stabilized (PP-B) with Master Batches UV stabilized (Grade 8, ASTM D2565, 1-8)
Gasket
Food safe rubber (NBR); 70 sh
Reinforcement ring
Stainless Steel AISI 430
Bolts and nuts
stainless steel or galvanized

Standards

For PE pipe:
ISO 11922-1; ISO 4427; DIN 8074; AS/NZS 4130;
EN 12201-1/2; BS 6572; BS 6730; UNI 7990
For PVC pipe:
UNI EN 1452-1/2
Threads:
ISO 7-1; DIN EN 10226-1; BS 21; AS 1722.1

Test Standards

ISO 13460; AS/NZS 4129

654X - Blue clamp saddles with stainless steel reinforcement ring, flat gasket and stainless steel bolts and nuts (PN16-PN10)



- water PN16-10
- suitable for PE and PVC pipes
- material: PP
- female thread: ISO 7 (parallel)
- gasket: O-ring with flat lip (NBR)
- reinforcement ring: stainless steel AISI430
- bolts and nuts : stainless steel
- colour: blue
- B= N° of bolts
- M= bolt type
- (*) with O-ring gasket

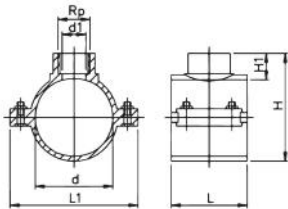

| | d (mm) | Rp (inch) | PN (bar) | B | M | Code | SP | GP | Weight (kg) |
|---|-----------|--------------|-------------|---|-------|-------------|----|-----|----------------|
| * | 20 | ½ | 16 | 2 | M8X40 | 727 627 001 | 1 | 180 | 0.121 |
| * | 25 | ½ | 16 | 2 | M8X30 | 727 627 011 | 1 | 150 | 0.110 |
| * | 25 | ¾ | 16 | 2 | M8X30 | 727 627 012 | 1 | 150 | 0.123 |
| * | 32 | ½ | 16 | 2 | M8X30 | 727 627 021 | 1 | 150 | 0.103 |
| * | 32 | ¾ | 16 | 2 | M8X30 | 727 627 022 | 1 | 150 | 0.115 |
| * | 32 | 1 | 16 | 2 | M8X40 | 727 627 023 | 1 | 100 | 0.164 |
| | 40 | ½ | 16 | 2 | M8X40 | 727 627 031 | 1 | 100 | 0.137 |
| | 40 | ¾ | 16 | 2 | M8X40 | 727 627 032 | 1 | 100 | 0.148 |
| | 40 | 1 | 16 | 2 | M8X40 | 727 627 033 | 1 | 100 | 0.155 |
| | 50 | ½ | 16 | 4 | M8X40 | 727 627 041 | 1 | 100 | 0.200 |
| | 50 | ¾ | 16 | 4 | M8X40 | 727 627 042 | 1 | 100 | 0.213 |
| | 50 | 1 | 16 | 4 | M8X40 | 727 627 043 | 1 | 100 | 0.221 |
| | 50 | 1 ¼ | 16 | 4 | M8X40 | 727 627 044 | 1 | 100 | 0.225 |
| | 63 | ½ | 16 | 4 | M8X40 | 727 627 051 | 1 | 60 | 0.216 |
| | 63 | ¾ | 16 | 4 | M8X40 | 727 627 052 | 1 | 60 | 0.215 |
| | 63 | 1 | 16 | 4 | M8X40 | 727 627 053 | 1 | 60 | 0.226 |
| | 63 | 1 ¼ | 16 | 4 | M8X40 | 727 627 054 | 1 | 50 | 0.272 |
| | 63 | 1 ½ | 16 | 4 | M8X40 | 727 627 055 | 1 | 50 | 0.279 |
| | 75 | ½ | 16 | 4 | M8X60 | 727 627 061 | 1 | 40 | 0.364 |
| | 75 | ¾ | 16 | 4 | M8X60 | 727 627 062 | 1 | 40 | 0.362 |
| | 75 | 1 | 16 | 4 | M8X60 | 727 627 063 | 1 | 40 | 0.384 |
| | 75 | 1 ¼ | 16 | 4 | M8X60 | 727 627 064 | 1 | 40 | 0.421 |
| | 75 | 1 ½ | 16 | 4 | M8X60 | 727 627 065 | 1 | 40 | 0.428 |
| | 75 | 2 | 16 | 4 | M8X60 | 727 627 066 | 1 | 40 | 0.437 |
| | 90 | ½ | 16 | 4 | M8X60 | 727 627 071 | 1 | 34 | 0.412 |
| | 90 | ¾ | 16 | 4 | M8X60 | 727 627 072 | 1 | 34 | 0.421 |
| | 90 | 1 | 16 | 4 | M8X60 | 727 627 073 | 1 | 34 | 0.432 |
| | 90 | 1 ¼ | 16 | 4 | M8X60 | 727 627 074 | 1 | 34 | 0.472 |
| | 90 | 1 ½ | 16 | 4 | M8X60 | 727 627 075 | 1 | 30 | 0.474 |
| | 90 | 2 | 16 | 4 | M8X60 | 727 627 076 | 1 | 30 | 0.481 |
| | 110 | ½ | 16 | 6 | M8X50 | 158 050 498 | 1 | 20 | 0.511 |
| | 110 | ¾ | 16 | 6 | M8X50 | 727 627 082 | 1 | 20 | 0.523 |
| | 110 | 1 | 16 | 6 | M8X50 | 727 627 083 | 1 | 20 | 0.510 |
| | 110 | 1 ¼ | 16 | 6 | M8X50 | 727 627 084 | 1 | 20 | 0.565 |
| | 110 | 1 ½ | 16 | 6 | M8X50 | 727 627 085 | 1 | 20 | 0.545 |
| | 110 | 2 | 16 | 6 | M8X50 | 727 627 086 | 1 | 20 | 0.570 |
| | 110 | 3 | 6 | 6 | M8X70 | 727 627 087 | 1 | 12 | 1.108 |
| | 125 | ½ | 16 | 6 | M8X50 | 727 627 091 | 1 | 20 | 0.578 |
| | 125 | ¾ | 16 | 6 | M8X50 | 727 627 092 | 1 | 20 | 0.590 |
| | 125 | 1 | 16 | 6 | M8X50 | 727 627 093 | 1 | 20 | 0.592 |
| | 125 | 1 ¼ | 16 | 6 | M8X50 | 727 627 094 | 1 | 20 | 0.629 |
| | 125 | 1 ½ | 16 | 6 | M8X50 | 727 627 095 | 1 | 20 | 0.627 |
| | 125 | 2 | 16 | 6 | M8X50 | 727 627 096 | 1 | 20 | 0.640 |
| | 125 | 3 | 6 | 6 | M8X70 | 727 627 097 | 1 | 12 | 1.009 |
| | 125 | 4 | 6 | 6 | M8X70 | 727 627 098 | 1 | 12 | 1.051 |
| | 140 | ½ | 16 | 6 | M8X70 | 727 627 101 | 1 | 12 | 0.830 |
| | 140 | ¾ | 16 | 6 | M8X70 | 727 627 102 | 1 | 12 | 0.843 |
| | 140 | 1 | 16 | 6 | M8X70 | 727 627 103 | 1 | 12 | 0.849 |
| | 140 | 1 ¼ | 16 | 6 | M8X70 | 727 627 104 | 1 | 12 | 0.880 |

table continued on the next page

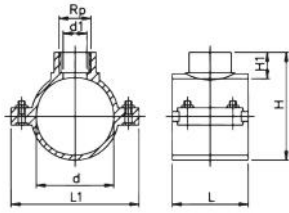

| | d (mm) | Rp (inch) | PN (bar) | B | M | Code | SP | GP | Weight (kg) |
|---|-----------|--------------|-------------|---|---------|--------------------|----|----|----------------|
| | 140 | 1 1/2 | 16 | 6 | M8X70 | 727 627 105 | 1 | 12 | 0.892 |
| | 140 | 2 | 16 | 6 | M8X70 | 727 627 106 | 1 | 12 | 0.898 |
| | 140 | 3 | 10 | 6 | M8X70 | 727 627 107 | 1 | 8 | 1.132 |
| | 140 | 4 | 10 | 6 | M8X70 | 727 627 108 | 1 | 8 | 1.196 |
| | 160 | 1/2 | 16 | 6 | M8X70 | 727 627 111 | 1 | 12 | 0.899 |
| | 160 | 3/4 | 16 | 6 | M8X70 | 727 627 112 | 1 | 12 | 0.908 |
| | 160 | 1 | 16 | 6 | M8X70 | 727 627 113 | 1 | 12 | 0.917 |
| | 160 | 1 1/4 | 16 | 6 | M8X70 | 727 627 114 | 1 | 12 | 0.950 |
| | 160 | 1 1/2 | 16 | 6 | M8X70 | 727 627 115 | 1 | 12 | 0.954 |
| | 160 | 2 | 16 | 6 | M8X70 | 727 627 116 | 1 | 12 | 0.956 |
| | 160 | 3 | 10 | 6 | M8X70 | 727 627 117 | 1 | 8 | 1.185 |
| | 160 | 4 | 10 | 6 | M8X70 | 727 627 118 | 1 | 8 | 1.262 |
| * | 180 | 1 | 10 | 6 | M10x80 | 727 627 123 | 1 | 4 | 1.980 |
| * | 180 | 1 1/4 | 10 | 6 | M10x80 | 727 627 124 | 1 | 4 | 2.013 |
| * | 180 | 1 1/2 | 10 | 6 | M10x80 | 727 627 125 | 1 | 4 | 2.007 |
| * | 180 | 2 | 10 | 6 | M10x80 | 727 627 126 | 1 | 4 | 2.018 |
| * | 180 | 3 | 10 | 6 | M10x80 | 727 627 127 | 1 | 4 | 2.043 |
| * | 180 | 4 | 10 | 6 | M10x80 | 727 627 128 | 1 | 4 | 2.092 |
| * | 200 | 1 1/2 | 10 | 6 | M10x80 | 727 627 135 | 1 | 4 | 1.966 |
| * | 200 | 2 | 10 | 6 | M10x80 | 727 627 136 | 1 | 4 | 1.946 |
| * | 200 | 3 | 10 | 6 | M10x80 | 727 627 137 | 1 | 4 | 1.980 |
| * | 200 | 4 | 10 | 6 | M10x80 | 727 627 138 | 1 | 4 | 2.020 |
| * | 225 | 1 1/2 | 10 | 6 | M10x80 | 727 627 145 | 1 | 3 | 2.049 |
| * | 225 | 2 | 10 | 6 | M10x80 | 727 627 146 | 1 | 3 | 2.049 |
| * | 225 | 3 | 10 | 6 | M10x80 | 727 627 147 | 1 | 3 | 2.150 |
| * | 225 | 4 | 10 | 6 | M10x80 | 727 627 148 | 1 | 3 | 2.184 |
| * | 250 | 2 | 10 | 6 | M10x80 | 727 627 156 | 1 | 3 | 2.472 |
| * | 250 | 3 | 10 | 6 | M10x80 | 727 627 157 | 1 | 3 | 2.466 |
| * | 250 | 4 | 10 | 6 | M10x80 | 727 627 158 | 1 | 3 | 2.478 |
| | 280 | 2 | 10 | 6 | M10x160 | 727 627 166 | 1 | 2 | 3.440 |
| * | 280 | 3 | 10 | 6 | M10x160 | 727 627 167 | 1 | 2 | 3.543 |
| * | 280 | 4 | 10 | 6 | M10x160 | 727 627 168 | 1 | 0 | 3.585 |
| | 315 | 2 | 10 | 6 | M10x110 | 727 627 176 | 1 | 0 | 4.156 |
| * | 315 | 3 | 10 | 6 | M10x110 | 727 627 177 | 1 | 0 | 4.267 |
| * | 315 | 4 | 10 | 6 | M10x110 | 727 627 178 | 1 | 0 | 4.279 |

| | d (mm) | Rp (inch) | d1 (mm) | L (mm) | L1 (mm) | H (mm) | H1 (mm) |
|---|-----------|--------------|------------|-----------|------------|-----------|------------|
| * | 20 | 1/2 | 12 | 46 | 77 | 59 | 26 |
| * | 25 | 1/2 | 13 | 49 | 79 | 58 | 15 |
| * | 25 | 3/4 | 13 | 49 | 79 | 58 | 15 |
| * | 32 | 1/2 | 14 | 49 | 79 | 62 | 20 |
| * | 32 | 3/4 | 14 | 49 | 79 | 62 | 20 |
| * | 32 | 1 | 14 | 62 | 87 | 70 | 20 |
| | 40 | 1/2 | 21 | 62 | 86 | 71 | 20 |
| | 40 | 3/4 | 21 | 62 | 86 | 71 | 20 |
| | 40 | 1 | 21 | 62 | 86 | 70 | 19 |
| | 50 | 1/2 | 21 | 62 | 86 | 82 | 20 |
| | 50 | 3/4 | 21 | 62 | 86 | 82 | 20 |
| | 50 | 1 | 21 | 62 | 86 | 82 | 20 |
| | 50 | 1 1/4 | 21 | 62 | 86 | 82 | 20 |
| | 63 | 1/2 | 18 | 62 | 101 | 96 | 21 |
| | 63 | 3/4 | 24 | 62 | 101 | 96 | 21 |
| | 63 | 1 | 31 | 62 | 101 | 96 | 21 |
| | 63 | 1 1/4 | 31 | 62 | 101 | 96 | 21 |
| | 63 | 1 1/2 | 31 | 62 | 101 | 96 | 21 |
| | 75 | 1/2 | 16 | 79 | 123 | 102 | 14 |
| | 75 | 3/4 | 21 | 79 | 123 | 104 | 16 |
| | 75 | 1 | 27 | 79 | 123 | 107 | 19 |
| | 75 | 1 1/4 | 35 | 79 | 123 | 109 | 21 |
| | 75 | 1 1/2 | 42 | 79 | 123 | 109 | 21 |
| | 75 | 2 | 53 | 79 | 123 | 112 | 24 |
| | 90 | 1/2 | 16 | 87 | 138 | 116 | 14 |

table continued on the next page

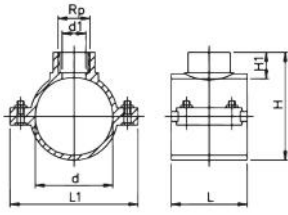

| d | Rp | d1 | L | L1 | H | H1 | |
|------|--------|------|------|------|------|------|----|
| (mm) | (inch) | (mm) | (mm) | (mm) | (mm) | (mm) | |
| 90 | ¾ | 21 | 87 | 138 | 118 | 16 | |
| 90 | 1 | 27 | 87 | 138 | 121 | 19 | |
| 90 | 1 ¼ | 35 | 87 | 138 | 123 | 21 | |
| 90 | 1 ½ | 42 | 87 | 138 | 123 | 21 | |
| 90 | 2 | 53 | 87 | 138 | 126 | 24 | |
| 110 | ½ | 15 | 99 | 152 | 150 | 23 | |
| 110 | ¾ | 20 | 99 | 152 | 150 | 23 | |
| 110 | 1 | 26 | 99 | 152 | 150 | 23 | |
| 110 | 1 ¼ | 35 | 99 | 152 | 150 | 23 | |
| 110 | 1 ½ | 41 | 99 | 152 | 150 | 23 | |
| 110 | 2 | 51 | 99 | 152 | 150 | 23 | |
| 110 | 3 | 85 | 99 | 152 | 150 | 23 | |
| 125 | ½ | 15 | 101 | 166 | 169 | 24 | |
| 125 | ¾ | 20 | 101 | 166 | 169 | 24 | |
| 125 | 1 | 26 | 101 | 166 | 169 | 24 | |
| 125 | 1 ¼ | 35 | 101 | 166 | 168 | 23 | |
| 125 | 1 ½ | 41 | 101 | 166 | 168 | 23 | |
| 125 | 2 | 50 | 101 | 166 | 168 | 23 | |
| 125 | 3 | 85 | 139 | 178 | 180 | 37 | |
| 125 | 4 | 90 | 139 | 178 | 181 | 38 | |
| 140 | ½ | 18 | 114 | 207 | 191 | 25 | |
| 140 | ¾ | 24 | 114 | 207 | 191 | 25 | |
| 140 | 1 | 30 | 114 | 207 | 191 | 25 | |
| 140 | 1 ¼ | 38 | 114 | 207 | 191 | 25 | |
| 140 | 1 ½ | 45 | 114 | 207 | 191 | 24 | |
| 140 | 2 | 50 | 114 | 207 | 191 | 24 | |
| 140 | 3 | 85 | 142 | 208 | 201 | 38 | |
| 140 | 4 | 90 | 142 | 208 | 201 | 38 | |
| 160 | ½ | 18 | 114 | 226 | 215 | 24 | |
| 160 | ¾ | 24 | 114 | 226 | 215 | 24 | |
| 160 | 1 | 30 | 114 | 226 | 215 | 24 | |
| 160 | 1 ¼ | 37 | 114 | 226 | 215 | 24 | |
| 160 | 1 ½ | 45 | 114 | 226 | 215 | 24 | |
| 160 | 2 | 51 | 114 | 226 | 215 | 24 | |
| 160 | 3 | 84 | 142 | 228 | 222 | 24 | |
| 160 | 4 | 90 | 142 | 228 | 222 | 24 | |
| * | 180 | 1 | 30 | 169 | 262 | 265 | 38 |
| * | 180 | 1 ¼ | 36 | 169 | 262 | 265 | 38 |
| * | 180 | 1 ½ | 42 | 169 | 262 | 265 | 38 |
| * | 180 | 2 | 54 | 169 | 262 | 265 | 38 |
| * | 180 | 3 | 84 | 169 | 262 | 265 | 38 |
| * | 180 | 4 | 108 | 169 | 262 | 265 | 38 |
| * | 200 | 1 ½ | 45 | 169 | 262 | 265 | 38 |
| * | 200 | 2 | 54 | 169 | 262 | 265 | 38 |
| * | 200 | 3 | 85 | 169 | 262 | 265 | 38 |
| * | 200 | 4 | 103 | 169 | 262 | 267 | 40 |
| * | 225 | 1 ½ | 45 | 174 | 287 | 287 | 26 |
| * | 225 | 2 | 51 | 174 | 287 | 287 | 26 |
| * | 225 | 3 | 85 | 174 | 287 | 295 | 37 |
| * | 225 | 4 | 103 | 174 | 287 | 295 | 38 |
| * | 250 | 2 | 55 | 178 | 310 | 314 | 38 |
| * | 250 | 3 | 85 | 178 | 310 | 314 | 38 |
| * | 250 | 4 | 103 | 178 | 310 | 314 | 38 |
| | 280 | 2 | 51 | 179 | 335 | 326 | 31 |
| * | 280 | 3 | 78 | 179 | 335 | 338 | 41 |
| * | 280 | 4 | 98 | 179 | 335 | 338 | 46 |
| | 315 | 2 | 51 | 246 | 390 | 350 | 31 |
| * | 315 | 3 | 78 | 246 | 390 | 363 | 41 |
| * | 315 | 4 | 98 | 246 | 390 | 363 | 46 |

654 - Blue clamp saddles with stainless steel reinforcing ring, flat gasket and galvanized bolts and nuts (PN16-PN10)



- bolts and nuts : galvanized
- colour: blue
- B= N° of bolts
- M= bolt type
- (*) with O-ring gasket
- water PN16-10
- suitable for PE and PVC pipes
- female thread: ISO 7 (parallel)
- gasket: O-ring with flat lip (NBR)
- material: PP
- reinforcement ring: stainless steel AISI430

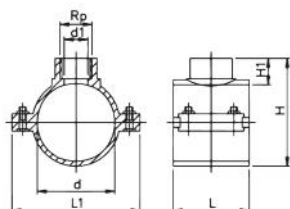

| | d (mm) | Rp (inch) | PN (bar) | B | M | Code | SP | GP | Weight (kg) |
|---|-----------|--------------|-------------|---|-------|-------------|----|-----|----------------|
| * | 20 | ½ | 16 | 2 | M8X40 | 158 001 041 | 1 | 180 | 0.119 |
| * | 25 | ½ | 16 | 2 | M8X30 | 158 001 042 | 1 | 150 | 0.110 |
| * | 25 | ¾ | 16 | 2 | M8X30 | 158 001 043 | 1 | 150 | 0.123 |
| * | 32 | ½ | 16 | 2 | M8X30 | 158 001 044 | 1 | 150 | 0.103 |
| * | 32 | ¾ | 16 | 2 | M8X30 | 158 001 045 | 1 | 150 | 0.115 |
| * | 32 | 1 | 16 | 2 | M8X40 | 158 001 046 | 1 | 100 | 0.162 |
| | 40 | ½ | 16 | 2 | M8X40 | 158 001 047 | 1 | 100 | 0.135 |
| | 40 | ¾ | 16 | 2 | M8X40 | 158 001 048 | 1 | 100 | 0.146 |
| | 40 | 1 | 16 | 2 | M8X40 | 158 001 049 | 1 | 100 | 0.153 |
| | 50 | ½ | 16 | 4 | M8X40 | 158 001 050 | 1 | 100 | 0.196 |
| | 50 | ¾ | 16 | 4 | M8X40 | 158 001 051 | 1 | 100 | 0.209 |
| | 50 | 1 | 16 | 4 | M8X40 | 158 001 052 | 1 | 100 | 0.217 |
| | 50 | 1 ¼ | 16 | 4 | M8X40 | 158 001 053 | 1 | 100 | 0.221 |
| | 63 | ½ | 16 | 4 | M8X40 | 158 001 054 | 1 | 60 | 0.212 |
| | 63 | ¾ | 16 | 4 | M8X40 | 158 001 055 | 1 | 60 | 0.222 |
| | 63 | 1 | 16 | 4 | M8X40 | 158 001 056 | 1 | 60 | 0.228 |
| | 63 | 1 ¼ | 16 | 4 | M8X40 | 158 001 058 | 1 | 50 | 0.268 |
| | 63 | 1 ½ | 16 | 4 | M8X40 | 158 001 057 | 1 | 50 | 0.275 |
| | 75 | ½ | 16 | 4 | M8X60 | 158 001 059 | 1 | 40 | 0.364 |
| | 75 | ¾ | 16 | 4 | M8X60 | 158 001 060 | 1 | 40 | 0.376 |
| | 75 | 1 | 16 | 4 | M8X60 | 158 001 061 | 1 | 40 | 0.384 |
| | 75 | 1 ¼ | 16 | 4 | M8X60 | 158 001 063 | 1 | 40 | 0.421 |
| | 75 | 1 ½ | 16 | 4 | M8X60 | 158 001 062 | 1 | 40 | 0.428 |
| | 75 | 2 | 16 | 4 | M8X60 | 158 001 064 | 1 | 40 | 0.437 |
| | 90 | ½ | 16 | 4 | M8X60 | 158 001 065 | 1 | 34 | 0.412 |
| | 90 | ¾ | 16 | 4 | M8X60 | 158 001 066 | 1 | 34 | 0.421 |
| | 90 | 1 | 16 | 4 | M8X60 | 158 001 067 | 1 | 34 | 0.432 |
| | 90 | 1 ¼ | 16 | 4 | M8X60 | 158 001 069 | 1 | 34 | 0.472 |
| | 90 | 1 ½ | 16 | 4 | M8X60 | 158 001 068 | 1 | 30 | 0.474 |
| | 90 | 2 | 16 | 4 | M8X60 | 158 001 070 | 1 | 30 | 0.481 |
| | 110 | ½ | 16 | 6 | M8X50 | 158 001 071 | 1 | 20 | 0.511 |
| | 110 | ¾ | 16 | 6 | M8X50 | 158 001 072 | 1 | 20 | 0.523 |
| | 110 | 1 | 16 | 6 | M8X50 | 158 001 073 | 1 | 20 | 0.533 |
| | 110 | 1 ¼ | 16 | 6 | M8X50 | 158 001 075 | 1 | 20 | 0.565 |
| | 110 | 1 ½ | 16 | 6 | M8X50 | 158 001 074 | 1 | 20 | 0.566 |
| | 110 | 2 | 16 | 6 | M8X50 | 158 001 076 | 1 | 20 | 0.570 |
| | 110 | 3 | 6 | 6 | M8x70 | 158 001 077 | 1 | 12 | 1.108 |
| | 125 | ½ | 16 | 6 | M8X50 | 158 001 078 | 1 | 20 | 0.578 |
| | 125 | ¾ | 16 | 6 | M8X50 | 158 001 079 | 1 | 20 | 0.590 |
| | 125 | 1 | 16 | 6 | M8X50 | 158 001 080 | 1 | 20 | 0.592 |
| | 125 | 1 ¼ | 16 | 6 | M8X50 | 158 001 082 | 1 | 20 | 0.629 |
| | 125 | 1 ½ | 16 | 6 | M8X50 | 158 001 081 | 1 | 20 | 0.627 |
| | 125 | 2 | 16 | 6 | M8X50 | 158 001 083 | 1 | 20 | 0.640 |
| | 125 | 3 | 6 | 6 | M8X70 | 158 001 084 | 1 | 12 | 1.009 |
| | 125 | 4 | 6 | 6 | M8X70 | 158 001 085 | 1 | 12 | 1.051 |
| | 140 | ½ | 16 | 6 | M8X70 | 158 001 086 | 1 | 12 | 0.830 |
| | 140 | ¾ | 16 | 6 | M8X70 | 158 001 087 | 1 | 12 | 0.843 |
| | 140 | 1 | 16 | 6 | M8X70 | 158 001 088 | 1 | 12 | 0.849 |
| | 140 | 1 ¼ | 16 | 6 | M8X70 | 158 001 090 | 1 | 12 | 0.880 |

table continued on the next page

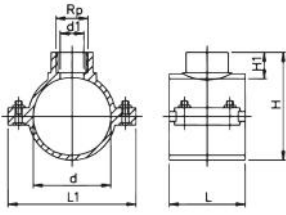

| | d (mm) | Rp (inch) | PN (bar) | B | M | Code | SP | GP | Weight (kg) |
|---|-----------|--------------|-------------|---|---------|-------------|----|----|----------------|
| | 140 | 1 1/2 | 16 | 6 | M8X70 | 158 001 089 | 1 | 12 | 0.892 |
| | 140 | 2 | 16 | 6 | M8X70 | 158 001 091 | 1 | 12 | 0.898 |
| | 140 | 3 | 10 | 6 | M8X70 | 158 001 092 | 1 | 8 | 1.132 |
| | 140 | 4 | 10 | 6 | M8X70 | 158 001 093 | 1 | 8 | 1.196 |
| | 160 | 1/2 | 16 | 6 | M8X70 | 158 001 094 | 1 | 12 | 0.899 |
| | 160 | 3/4 | 16 | 6 | M8X70 | 158 001 095 | 1 | 12 | 0.908 |
| | 160 | 1 | 16 | 6 | M8X70 | 158 001 096 | 1 | 12 | 0.917 |
| | 160 | 1 1/4 | 16 | 6 | M8X70 | 158 001 098 | 1 | 12 | 0.950 |
| | 160 | 1 1/2 | 16 | 6 | M8X70 | 158 001 097 | 1 | 12 | 0.954 |
| | 160 | 2 | 16 | 6 | M8X70 | 158 001 099 | 1 | 12 | 0.956 |
| | 160 | 3 | 10 | 6 | M8X70 | 158 001 100 | 1 | 8 | 1.185 |
| | 160 | 4 | 10 | 6 | M8X70 | 158 001 101 | 1 | 8 | 1.262 |
| * | 180 | 1 | 10 | 6 | M10X80 | 158 001 102 | 1 | 4 | 1.980 |
| * | 180 | 1 1/2 | 10 | 6 | M10X80 | 158 001 103 | 1 | 4 | 2.007 |
| * | 180 | 1 1/4 | 10 | 6 | M10X80 | 158 001 104 | 1 | 4 | 2.013 |
| * | 180 | 2 | 10 | 6 | M10X80 | 158 001 105 | 1 | 4 | 2.018 |
| * | 180 | 3 | 10 | 6 | M10X80 | 158 001 106 | 1 | 4 | 2.043 |
| * | 180 | 4 | 10 | 6 | M10X80 | 158 001 107 | 1 | 4 | 2.092 |
| * | 200 | 1 1/2 | 10 | 6 | M10X80 | 158 001 108 | 1 | 4 | 1.966 |
| * | 200 | 2 | 10 | 6 | M10X80 | 158 001 109 | 1 | 4 | 1.946 |
| * | 200 | 3 | 10 | 6 | M10X80 | 158 001 110 | 1 | 4 | 1.980 |
| * | 200 | 4 | 10 | 6 | M10X80 | 158 001 111 | 1 | 4 | 2.020 |
| * | 225 | 1 1/2 | 10 | 6 | M10X80 | 158 001 112 | 1 | 3 | 2.049 |
| * | 225 | 2 | 10 | 6 | M10X80 | 158 001 113 | 1 | 3 | 2.050 |
| * | 225 | 3 | 10 | 6 | M10X80 | 158 001 114 | 1 | 3 | 2.150 |
| * | 225 | 4 | 10 | 6 | M10X80 | 158 001 115 | 1 | 3 | 2.184 |
| * | 250 | 2 | 10 | 6 | M10X80 | 158 001 116 | 1 | 3 | 2.472 |
| * | 250 | 3 | 10 | 6 | M10X80 | 158 001 117 | 1 | 3 | 2.466 |
| * | 250 | 4 | 10 | 6 | M10X80 | 158 001 118 | 1 | 3 | 2.478 |
| | 280 | 2 | 10 | 6 | M10X160 | 158 001 119 | 1 | 2 | 3.440 |
| * | 280 | 3 | 10 | 6 | M10X160 | 158 001 120 | 1 | 2 | 3.543 |
| * | 280 | 4 | 10 | 6 | M10X160 | 158 001 121 | 1 | 2 | 3.585 |
| | 315 | 2 | 10 | 6 | M10X110 | 158 001 122 | 1 | 0 | 4.156 |
| * | 315 | 3 | 10 | 6 | M10X110 | 158 001 123 | 1 | 0 | 4.267 |
| * | 315 | 4 | 10 | 6 | M10X110 | 158 001 124 | 1 | 0 | 4.279 |

| | d (mm) | Rp (inch) | d1 (mm) | L (mm) | L1 (mm) | H (mm) | H1 (mm) |
|---|-----------|--------------|------------|-----------|------------|-----------|------------|
| * | 20 | 1/2 | 12 | 46 | 77 | 59 | 26 |
| * | 25 | 1/2 | 13 | 49 | 79 | 58 | 15 |
| * | 25 | 3/4 | 13 | 49 | 79 | 58 | 15 |
| * | 32 | 1/2 | 14 | 49 | 79 | 62 | 20 |
| * | 32 | 3/4 | 14 | 49 | 79 | 62 | 20 |
| * | 32 | 1 | 14 | 62 | 87 | 70 | 20 |
| | 40 | 1/2 | 21 | 62 | 86 | 71 | 20 |
| | 40 | 3/4 | 21 | 62 | 86 | 71 | 20 |
| | 40 | 1 | 21 | 62 | 86 | 70 | 19 |
| | 50 | 1/2 | 21 | 62 | 86 | 82 | 20 |
| | 50 | 3/4 | 21 | 62 | 86 | 82 | 20 |
| | 50 | 1 | 21 | 62 | 86 | 82 | 20 |
| | 50 | 1 1/4 | 21 | 62 | 86 | 82 | 20 |
| | 63 | 1/2 | 18 | 62 | 101 | 96 | 21 |
| | 63 | 3/4 | 24 | 62 | 101 | 96 | 21 |
| | 63 | 1 | 31 | 62 | 101 | 96 | 21 |
| | 63 | 1 1/4 | 31 | 62 | 101 | 96 | 21 |
| | 63 | 1 1/2 | 31 | 62 | 101 | 96 | 21 |
| | 75 | 1/2 | 16 | 79 | 123 | 102 | 14 |
| | 75 | 3/4 | 21 | 79 | 123 | 104 | 16 |
| | 75 | 1 | 27 | 79 | 123 | 107 | 19 |
| | 75 | 1 1/4 | 35 | 79 | 123 | 109 | 21 |
| | 75 | 1 1/2 | 42 | 79 | 123 | 109 | 21 |
| | 75 | 2 | 53 | 79 | 123 | 112 | 24 |
| | 90 | 1/2 | 16 | 87 | 138 | 116 | 14 |

table continued on the next page

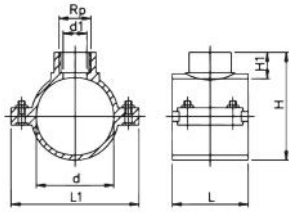

| | d (mm) | Rp (inch) | d1 (mm) | L (mm) | L1 (mm) | H (mm) | H1 (mm) |
|---|-----------|--------------|------------|-----------|------------|-----------|------------|
| | 90 | ¾ | 21 | 87 | 138 | 118 | 16 |
| | 90 | 1 | 27 | 87 | 138 | 121 | 19 |
| | 90 | 1 ¼ | 35 | 87 | 138 | 123 | 21 |
| | 90 | 1 ½ | 42 | 87 | 138 | 123 | 21 |
| | 90 | 2 | 53 | 87 | 138 | 126 | 24 |
| | 110 | ½ | 15 | 99 | 152 | 150 | 23 |
| | 110 | ¾ | 20 | 99 | 152 | 150 | 23 |
| | 110 | 1 | 26 | 99 | 152 | 150 | 23 |
| | 110 | 1 ¼ | 35 | 99 | 152 | 150 | 23 |
| | 110 | 1 ½ | 41 | 99 | 152 | 150 | 23 |
| | 110 | 2 | 51 | 99 | 152 | 150 | 23 |
| | 110 | 3 | 85 | 99 | 152 | 150 | 23 |
| | 125 | ½ | 15 | 101 | 166 | 169 | 24 |
| | 125 | ¾ | 20 | 101 | 166 | 169 | 24 |
| | 125 | 1 | 26 | 101 | 166 | 169 | 24 |
| | 125 | 1 ¼ | 35 | 101 | 166 | 168 | 23 |
| | 125 | 1 ½ | 41 | 101 | 166 | 168 | 23 |
| | 125 | 2 | 50 | 101 | 166 | 168 | 23 |
| | 125 | 3 | 85 | 139 | 178 | 180 | 37 |
| | 125 | 4 | 90 | 139 | 178 | 181 | 38 |
| | 140 | ½ | 18 | 114 | 207 | 191 | 25 |
| | 140 | ¾ | 24 | 114 | 207 | 191 | 25 |
| | 140 | 1 | 30 | 114 | 207 | 191 | 25 |
| | 140 | 1 ¼ | 38 | 114 | 207 | 191 | 25 |
| | 140 | 1 ½ | 45 | 114 | 207 | 191 | 24 |
| | 140 | 2 | 50 | 114 | 207 | 191 | 24 |
| | 140 | 3 | 85 | 142 | 208 | 201 | 38 |
| | 140 | 4 | 90 | 142 | 208 | 201 | 38 |
| | 160 | ½ | 18 | 114 | 226 | 215 | 24 |
| | 160 | ¾ | 24 | 114 | 226 | 215 | 24 |
| | 160 | 1 | 30 | 114 | 226 | 215 | 24 |
| | 160 | 1 ¼ | 37 | 114 | 226 | 215 | 24 |
| | 160 | 1 ½ | 45 | 114 | 226 | 215 | 24 |
| | 160 | 2 | 51 | 114 | 226 | 215 | 24 |
| | 160 | 3 | 84 | 142 | 228 | 222 | 38 |
| | 160 | 4 | 90 | 142 | 228 | 222 | 38 |
| * | 180 | 1 | 30 | 169 | 262 | 265 | 38 |
| * | 180 | 1 ½ | 54 | 169 | 262 | 265 | 38 |
| * | 180 | 1 ¼ | 36 | 169 | 262 | 265 | 38 |
| * | 180 | 2 | 54 | 169 | 262 | 265 | 38 |
| * | 180 | 3 | 85 | 169 | 262 | 265 | 38 |
| * | 180 | 4 | 103 | 169 | 262 | 267 | 40 |
| * | 200 | 1 ½ | 45 | 169 | 262 | 265 | 38 |
| * | 200 | 2 | 54 | 169 | 262 | 265 | 38 |
| * | 200 | 3 | 85 | 169 | 262 | 265 | 38 |
| * | 200 | 4 | 103 | 169 | 262 | 267 | 40 |
| * | 225 | 1 ½ | 45 | 145 | 287 | 287 | 26 |
| * | 225 | 2 | 51 | 145 | 287 | 287 | 26 |
| * | 225 | 3 | 85 | 174 | 287 | 295 | 37 |
| * | 225 | 4 | 103 | 174 | 287 | 295 | 38 |
| * | 250 | 2 | 55 | 178 | 310 | 314 | 38 |
| * | 250 | 3 | 85 | 178 | 310 | 314 | 38 |
| * | 250 | 4 | 103 | 178 | 310 | 314 | 38 |
| | 280 | 2 | 51 | 179 | 335 | 326 | 31 |
| * | 280 | 3 | 78 | 179 | 335 | 338 | 41 |
| * | 280 | 4 | 98 | 179 | 335 | 338 | 46 |
| | 315 | 2 | 51 | 246 | 390 | 350 | 31 |
| * | 315 | 3 | 78 | 246 | 390 | 363 | 41 |
| * | 315 | 4 | 98 | 246 | 390 | 363 | 46 |

664 - Double blue clamp saddles with stainless steel reinforcing ring, flat gasket and galvanized bolts and nuts (PN16-PN10)

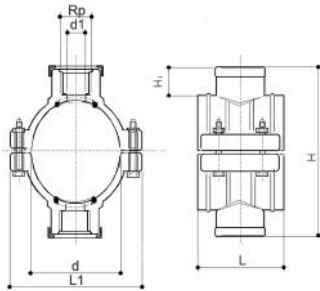

- female thread: ISO 7 (parallel)
- material: PP
- gasket: O-ring with flat lip (NBR)
- reinforcement ring: stainless steel AISI430
- bolts and nuts : galvanized
- colour: blue
- B= N° of bolts
- M= bolt type
- (*) with O-ring gasket
- water PN16-10
- suitable for PE and PVC pipes

| | d (mm) | Rp (inch) | PN (bar) | B | M | Code | SP | GP | Weight (kg) |
|---|-----------|--------------|-------------|---|-------|--------------------|----|----|----------------|
| * | 20 | ½ | 16 | 2 | M8X40 | 158 001 125 | 1 | 30 | 0.152 |
| * | 25 | ½ | 16 | 2 | M8X30 | 158 001 126 | 1 | 30 | 0.130 |
| * | 25 | ¾ | 16 | 2 | M8X30 | 158 001 127 | 1 | 30 | 0.156 |
| * | 32 | ½ | 16 | 2 | M8X30 | 158 001 128 | 1 | 30 | 0.124 |
| * | 32 | ¾ | 16 | 2 | M8X30 | 158 001 129 | 1 | 30 | 0.148 |
| * | 32 | 1 | 16 | 2 | M8X50 | 158 001 130 | 1 | 30 | 0.212 |
| | 40 | ½ | 16 | 2 | M8X50 | 158 001 131 | 1 | 30 | 0.168 |
| | 40 | ¾ | 16 | 2 | M8X50 | 158 001 132 | 1 | 30 | 0.190 |
| | 40 | 1 | 16 | 2 | M8X50 | 158 001 133 | 1 | 30 | 0.204 |
| | 50 | ½ | 16 | 4 | M8X50 | 158 001 134 | 1 | 30 | 0.236 |
| | 50 | ¾ | 16 | 4 | M8X50 | 158 001 135 | 1 | 30 | 0.262 |
| | 50 | 1 | 16 | 4 | M8X50 | 158 001 136 | 1 | 30 | 0.278 |
| | 50 | 1 ¼ | 16 | 4 | M8X50 | 158 001 137 | 1 | 30 | 0.286 |
| | 63 | ½ | 16 | 4 | M8X50 | 158 001 138 | 1 | 30 | 0.254 |
| | 63 | ¾ | 16 | 4 | M8X50 | 158 001 139 | 1 | 30 | 0.274 |
| | 63 | 1 | 16 | 4 | M8X50 | 158 001 140 | 1 | 30 | 0.286 |
| | 63 | 1 ¼ | 16 | 4 | M8X50 | 158 001 142 | 1 | 30 | 0.366 |
| | 63 | 1 ½ | 16 | 4 | M8X50 | 158 001 141 | 1 | 30 | 0.380 |
| | 75 | ½ | 16 | 4 | M8X70 | 158 001 143 | 1 | 20 | 0.392 |
| | 75 | ¾ | 16 | 4 | M8X70 | 158 001 144 | 1 | 20 | 0.416 |
| | 75 | 1 | 16 | 4 | M8X70 | 158 001 145 | 1 | 20 | 0.432 |
| | 75 | 1 ¼ | 16 | 4 | M8X70 | 158 001 147 | 1 | 20 | 0.506 |
| | 75 | 1 ½ | 16 | 4 | M8X70 | 158 001 146 | 1 | 20 | 0.520 |
| | 75 | 2 | 16 | 4 | M8X70 | 158 001 148 | 1 | 20 | 0.538 |
| | 90 | ½ | 16 | 4 | M8X70 | 158 001 149 | 1 | 15 | 0.440 |
| | 90 | ¾ | 16 | 4 | M8X70 | 158 001 150 | 1 | 15 | 0.458 |
| | 90 | 1 | 16 | 4 | M8X70 | 158 001 151 | 1 | 15 | 0.480 |
| | 90 | 1 ¼ | 16 | 4 | M8X70 | 158 001 153 | 1 | 15 | 0.560 |
| | 90 | 1 ½ | 16 | 4 | M8X70 | 158 001 152 | 1 | 15 | 0.564 |
| | 90 | 2 | 16 | 4 | M8X70 | 158 001 154 | 1 | 15 | 0.578 |
| | 110 | ½ | 16 | 6 | M8X70 | 158 001 155 | 1 | 5 | 0.572 |
| | 110 | ¾ | 16 | 6 | M8X70 | 158 001 156 | 1 | 5 | 0.596 |
| | 110 | 1 | 16 | 6 | M8X70 | 158 001 157 | 1 | 5 | 0.616 |
| | 110 | 1 ¼ | 16 | 6 | M8X70 | 158 001 159 | 1 | 5 | 0.680 |
| | 110 | 1 ½ | 16 | 6 | M8X70 | 158 001 158 | 1 | 5 | 0.682 |
| | 110 | 2 | 16 | 6 | M8X70 | 158 001 160 | 1 | 5 | 0.690 |
| | 110 | 3 | 6 | 6 | M8X70 | 158 001 161 | 1 | 4 | 1.362 |
| | 125 | ½ | 16 | 6 | M8X70 | 158 001 162 | 1 | 5 | 0.642 |
| | 125 | ¾ | 16 | 6 | M8X70 | 158 001 163 | 1 | 5 | 0.666 |
| | 125 | 1 | 16 | 6 | M8X70 | 158 001 164 | 1 | 5 | 0.670 |
| | 125 | 1 ¼ | 16 | 6 | M8X70 | 158 001 166 | 1 | 5 | 0.744 |
| | 125 | 1 ½ | 16 | 6 | M8X70 | 158 001 165 | 1 | 5 | 0.740 |
| | 125 | 2 | 16 | 6 | M8X70 | 158 001 167 | 1 | 5 | 0.766 |
| | 125 | 3 | 6 | 6 | M8X70 | 158 001 168 | 1 | 4 | 1.238 |
| | 125 | 4 | 6 | 6 | M8X70 | 158 001 169 | 1 | 4 | 1.322 |
| | 140 | ½ | 16 | 6 | M8X70 | 158 001 170 | 1 | 9 | 0.868 |
| | 140 | ¾ | 16 | 6 | M8X70 | 158 001 171 | 1 | 9 | 0.894 |
| | 140 | 1 | 16 | 6 | M8X70 | 158 001 172 | 1 | 9 | 0.906 |
| | 140 | 1 ¼ | 16 | 6 | M8X70 | 158 001 174 | 1 | 9 | 0.968 |

table continued on the next page

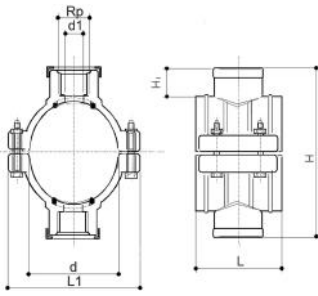

| | d (mm) | Rp (inch) | PN (bar) | B | M | Code | SP | GP | Weight (kg) |
|--|------------------|---------------------|--------------------|----------|----------|--------------------|-----------|-----------|-----------------------|
| | 140 | 1 ½ | 16 | 6 | M8X70 | 158 001 173 | 1 | 9 | 0.992 |
| | 140 | 2 | 16 | 6 | M8X70 | 158 001 175 | 1 | 9 | 1.004 |
| | 140 | 3 | 10 | 6 | M8X70 | 158 001 176 | 1 | 3 | 1.326 |
| | 140 | 4 | 10 | 6 | M8X70 | 158 001 177 | 1 | 3 | 1.454 |
| | 160 | ½ | 16 | 6 | M8X70 | 158 001 178 | 1 | 9 | 0.928 |
| | 160 | ¾ | 16 | 6 | M8X70 | 158 001 179 | 1 | 9 | 0.946 |
| | 160 | 1 | 16 | 6 | M8X70 | 158 001 180 | 1 | 9 | 0.964 |
| | 160 | 1 ¼ | 16 | 6 | M8X70 | 158 001 182 | 1 | 9 | 1.030 |
| | 160 | 1 ½ | 16 | 6 | M8X70 | 158 001 181 | 1 | 9 | 1.038 |
| | 160 | 2 | 16 | 6 | M8X70 | 158 001 183 | 1 | 9 | 1.042 |
| | 160 | 3 | 10 | 6 | M8X70 | 158 001 184 | 1 | 3 | 1.376 |
| | 160 | 4 | 10 | 6 | M8X70 | 158 001 185 | 1 | 3 | 1.530 |

| | d (mm) | Rp (inch) | PN (bar) | d1 (mm) | L (mm) | L1 (mm) | H (mm) | H1 (mm) |
|---|------------------|---------------------|--------------------|-------------------|------------------|-------------------|------------------|-------------------|
| * | 20 | ½ | 16 | 12 | 46 | 77 | 84 | 26 |
| * | 25 | ½ | 16 | 13 | 49 | 79 | 80 | 15 |
| * | 25 | ¾ | 16 | 13 | 49 | 79 | 80 | 15 |
| * | 32 | ½ | 16 | 14 | 49 | 79 | 80 | 20 |
| * | 32 | ¾ | 16 | 14 | 62 | 87 | 87 | 20 |
| * | 32 | 1 | 16 | 14 | 62 | 87 | 91 | 20 |
| | 40 | ½ | 16 | 21 | 62 | 86 | 91 | 20 |
| | 40 | ¾ | 16 | 21 | 62 | 86 | 91 | 20 |
| | 40 | 1 | 16 | 21 | 62 | 86 | 89 | 19 |
| | 50 | ½ | 16 | 21 | 62 | 86 | 101 | 20 |
| | 50 | ¾ | 16 | 21 | 62 | 86 | 101 | 20 |
| | 50 | 1 | 16 | 21 | 62 | 86 | 101 | 20 |
| | 50 | 1 ¼ | 16 | 21 | 62 | 86 | 101 | 20 |
| | 63 | ½ | 16 | 18 | 62 | 101 | 115 | 21 |
| | 63 | ¾ | 16 | 24 | 62 | 101 | 115 | 21 |
| | 63 | 1 | 16 | 31 | 62 | 101 | 115 | 21 |
| | 63 | 1 ¼ | 16 | 31 | 62 | 101 | 115 | 21 |
| | 63 | 1 ½ | 16 | 31 | 62 | 101 | 115 | 21 |
| | 75 | ½ | 16 | 16 | 79 | 123 | 115 | 14 |
| | 75 | ¾ | 16 | 21 | 79 | 123 | 119 | 16 |
| | 75 | 1 | 16 | 27 | 79 | 123 | 125 | 19 |
| | 75 | 1 ¼ | 16 | 35 | 79 | 123 | 129 | 21 |
| | 75 | 1 ½ | 16 | 42 | 79 | 123 | 129 | 21 |
| | 75 | 2 | 16 | 53 | 79 | 123 | 135 | 24 |
| | 90 | ½ | 16 | 16 | 87 | 138 | 129 | 14 |
| | 90 | ¾ | 16 | 21 | 87 | 138 | 133 | 16 |
| | 90 | 1 | 16 | 27 | 87 | 138 | 139 | 19 |
| | 90 | 1 ¼ | 16 | 35 | 87 | 138 | 145 | 21 |
| | 90 | 1 ½ | 16 | 42 | 87 | 138 | 145 | 21 |
| | 90 | 2 | 16 | 53 | 87 | 138 | 151 | 24 |
| | 110 | ½ | 16 | 15 | 99 | 152 | 169 | 23 |
| | 110 | ¾ | 16 | 20 | 99 | 152 | 169 | 23 |
| | 110 | 1 | 16 | 26 | 99 | 152 | 169 | 23 |
| | 110 | 1 ¼ | 16 | 35 | 99 | 152 | 169 | 23 |
| | 110 | 1 ½ | 16 | 41 | 99 | 152 | 169 | 23 |
| | 110 | 2 | 16 | 51 | 99 | 152 | 169 | 23 |
| | 110 | 3 | 6 | 85 | 99 | 152 | 169 | 23 |
| | 125 | ½ | 16 | 15 | 101 | 166 | 189 | 24 |
| | 125 | ¾ | 16 | 20 | 101 | 166 | 189 | 24 |
| | 125 | 1 | 16 | 26 | 101 | 166 | 189 | 24 |
| | 125 | 1 ¼ | 16 | 35 | 101 | 166 | 188 | 23 |
| | 125 | 1 ½ | 16 | 41 | 101 | 166 | 188 | 23 |
| | 125 | 2 | 16 | 50 | 101 | 166 | 188 | 23 |
| | 125 | 3 | 6 | 85 | 139 | 178 | 188 | 37 |
| | 125 | 4 | 6 | 90 | 139 | 178 | 188 | 38 |
| | 140 | ½ | 16 | 18 | 114 | 207 | 209 | 25 |
| | 140 | ¾ | 16 | 24 | 114 | 207 | 208 | 25 |
| | 140 | 1 | 16 | 30 | 114 | 207 | 208 | 25 |

table continued on the next page

PF 2 85 523 100

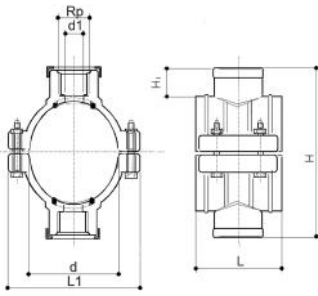

| d | Rp | PN | d1 | L | L1 | H | H1 |
|------|--------|-------|------|------|------|------|------|
| (mm) | (inch) | (bar) | (mm) | (mm) | (mm) | (mm) | (mm) |
| 140 | 1 ¼ | 16 | 38 | 114 | 207 | 208 | 25 |
| 140 | 1 ½ | 16 | 45 | 114 | 207 | 206 | 24 |
| 140 | 2 | 16 | 50 | 114 | 207 | 207 | 24 |
| 140 | 3 | 10 | 85 | 142 | 208 | 207 | 38 |
| 140 | 4 | 10 | 90 | 142 | 208 | 207 | 38 |
| 160 | ½ | 16 | 18 | 114 | 226 | 225 | 24 |
| 160 | ¾ | 16 | 24 | 114 | 226 | 225 | 24 |
| 160 | 1 | 16 | 30 | 114 | 226 | 225 | 24 |
| 160 | 1 ¼ | 16 | 37 | 114 | 226 | 225 | 24 |
| 160 | 1 ½ | 16 | 45 | 114 | 226 | 225 | 24 |
| 160 | 2 | 16 | 51 | 114 | 226 | 225 | 24 |
| 160 | 3 | 10 | 85 | 142 | 228 | 225 | 38 |
| 160 | 4 | 10 | 90 | 142 | 228 | 225 | 38 |

Black Clamp Saddles

Clamp saddles from d 20 up to d 110 mm, threaded branch from 1/2" to 2", provided with 2 or 4 bolts according to the diameter. Features: Robust design and anti-rotation ribs
Application: irrigation



+ Technical Specification

Pressure range

MOP of 12,5 bar from 20 mm up to 110 mm

Temperature range

-10 °C to +45 °C

Materials

Body

UV stabilized polypropylene (PP)

Gasket

Food-safe NBR rubber suitable for potable water.

Reinforcement ring

Stainless Steel AISI 430

Bolts and nuts

Galvanized

Standards

For PE pipe:

DIN EN 12201; ISO 11922-1; DIN 8074; EN 12201-1/2; AS/NZS 4130; BS 6572; BS 6730; ISO 4427; UNI 7990; ISO 12162

Threads:

DIN EN 10226 (ISO 7-1); BS 21; AS 1722.1

Test Standards

AS/NZS 4129
ISO 13460

150 - Black clamp saddles with O-ring gasket and galvanized bolts and nuts (PN12,5)

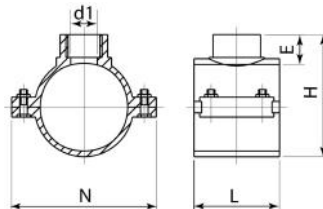

- B = No. of bolts
- M = bolt type
- suitable for PE and PVC pipes
- material: PP
- female thread: ISO 7 (parallel)

| d (mm) | Rp (inch) | PN (psi) | B | M | Code | SP | GP | Weight (kg) | d1 (mm) | L (mm) | L1 (mm) | H (mm) | H1 (mm) |
|-----------|--------------|-------------|---|-------|-------------|----|-----|----------------|------------|-----------|------------|-----------|------------|
| 20 | 1/2 | 12,5 | 2 | M8X30 | 158 001 590 | 1 | 180 | 0.109 | 12 | 46 | 77 | 59 | 26 |
| 25 | 1/2 | 12,5 | 2 | M8X30 | 158 001 591 | 1 | 150 | 0.100 | 13 | 49 | 79 | 58 | 15 |
| 25 | 3/4 | 12,5 | 2 | M8X30 | 158 001 592 | 1 | 150 | 0.104 | 13 | 49 | 79 | 58 | 15 |
| 32 | 1/2 | 12,5 | 2 | M8X30 | 158 001 593 | 1 | 150 | 0.093 | 14 | 49 | 79 | 62 | 20 |
| 32 | 3/4 | 12,5 | 2 | M8X30 | 158 001 594 | 1 | 150 | 0.097 | 14 | 49 | 79 | 62 | 20 |
| 32 | 1 | 12,5 | 2 | M8X30 | 158 001 595 | 1 | 100 | 0.139 | 14 | 62 | 87 | 70 | 20 |
| 40 | 1/2 | 12,5 | 2 | M8X40 | 158 001 596 | 1 | 100 | 0.124 | 21 | 62 | 86 | 71 | 20 |
| 40 | 3/4 | 12,5 | 2 | M8X40 | 158 001 597 | 1 | 100 | 0.125 | 21 | 62 | 86 | 71 | 20 |
| 40 | 1 | 12,5 | 2 | M8X40 | 158 001 598 | 1 | 100 | 0.128 | 21 | 62 | 86 | 70 | 19 |
| 50 | 1/2 | 12,5 | 2 | M8X40 | 158 001 599 | 1 | 100 | 0.134 | 21 | 62 | 86 | 82 | 20 |
| 50 | 3/4 | 12,5 | 2 | M8X40 | 158 001 600 | 1 | 100 | 0.087 | 21 | 62 | 86 | 82 | 20 |
| 50 | 1 | 12,5 | 2 | M8X40 | 158 001 601 | 1 | 100 | 0.139 | 21 | 62 | 86 | 82 | 20 |
| 50 | 1 1/4 | 12,5 | 2 | M8X40 | 158 001 602 | 1 | 100 | 0.137 | 21 | 62 | 86 | 82 | 20 |
| 63 | 1/2 | 12,5 | 4 | M8X40 | 158 001 605 | 1 | 70 | 0.201 | 18 | 62 | 101 | 96 | 21 |
| 63 | 3/4 | 12,5 | 4 | M8X40 | 158 001 606 | 1 | 70 | 0.203 | 24 | 62 | 101 | 96 | 21 |
| 63 | 1 | 12,5 | 4 | M8X40 | 158 001 607 | 1 | 70 | 0.205 | 31 | 62 | 101 | 96 | 21 |
| 63 | 1 1/4 | 12,5 | 4 | M8X40 | 158 001 609 | 1 | 60 | 0.211 | 31 | 62 | 101 | 96 | 21 |
| 63 | 1 1/2 | 12,5 | 4 | M8X40 | 158 001 608 | 1 | 60 | 0.218 | 31 | 62 | 101 | 96 | 21 |
| 75 | 1/2 | 12,5 | 4 | M8X70 | 158 001 610 | 1 | 40 | 0.342 | 16 | 79 | 123 | 102 | 14 |
| 75 | 3/4 | 12,5 | 4 | M8X70 | 158 001 611 | 1 | 40 | 0.345 | 21 | 79 | 123 | 104 | 16 |
| 75 | 1 | 12,5 | 4 | M8X70 | 158 001 612 | 1 | 40 | 0.349 | 27 | 79 | 123 | 107 | 19 |
| 75 | 1 1/4 | 12,5 | 4 | M8X70 | 158 001 614 | 1 | 40 | 0.352 | 35 | 79 | 123 | 109 | 21 |
| 75 | 1 1/2 | 12,5 | 4 | M8X70 | 158 001 613 | 1 | 40 | 0.354 | 42 | 79 | 123 | 109 | 21 |
| 75 | 2 | 12,5 | 4 | M8X70 | 158 001 615 | 1 | 40 | 0.366 | 53 | 79 | 123 | 112 | 24 |
| 90 | 1/2 | 12,5 | 4 | M8X70 | 158 001 616 | 1 | 34 | 0.391 | 16 | 87 | 138 | 116 | 14 |
| 90 | 3/4 | 12,5 | 4 | M8X70 | 158 001 617 | 1 | 34 | 0.363 | 21 | 87 | 138 | 118 | 16 |
| 90 | 1 | 12,5 | 4 | M8X70 | 158 001 618 | 1 | 34 | 0.396 | 27 | 87 | 138 | 121 | 19 |
| 90 | 1 1/4 | 12,5 | 4 | M8X70 | 158 001 620 | 1 | 34 | 0.403 | 35 | 87 | 138 | 123 | 21 |
| 90 | 1 1/2 | 12,5 | 4 | M8X70 | 158 001 619 | 1 | 30 | 0.404 | 42 | 87 | 138 | 123 | 21 |
| 90 | 2 | 12,5 | 4 | M8X70 | 158 001 621 | 1 | 30 | 0.412 | 53 | 87 | 138 | 126 | 24 |
| 110 | 1/2 | 12,5 | 4 | M8X50 | 158 001 622 | 1 | 13 | 0.439 | 15 | 99 | 152 | 150 | 23 |
| 110 | 3/4 | 12,5 | 4 | M8X50 | 158 001 623 | 1 | 20 | 0.433 | 20 | 99 | 152 | 150 | 23 |
| 110 | 1 | 12,5 | 4 | M8X50 | 158 001 624 | 1 | 20 | 0.430 | 26 | 99 | 152 | 150 | 23 |
| 110 | 1 1/4 | 12,5 | 4 | M8X50 | 158 001 626 | 1 | 20 | 0.433 | 35 | 99 | 152 | 150 | 23 |
| 110 | 1 1/2 | 12,5 | 4 | M8X50 | 158 001 625 | 1 | 20 | 0.439 | 41 | 99 | 152 | 150 | 23 |
| 110 | 2 | 12,5 | 4 | M8X50 | 158 001 627 | 1 | 20 | 0.443 | 51 | 99 | 152 | 150 | 23 |

Index

| Code | Page | Code | Page | Code | Page | Code | Page |
|-------------|------|-------------|------|-------------|------|-------------|------|
| 158 001 041 | 30 | 158 001 103 | 31 | 158 001 165 | 33 | 158 001 718 | 22 |
| 158 001 042 | 30 | 158 001 104 | 31 | 158 001 166 | 33 | 158 001 719 | 22 |
| 158 001 043 | 30 | 158 001 105 | 31 | 158 001 167 | 33 | 158 001 720 | 22 |
| 158 001 044 | 30 | 158 001 106 | 31 | 158 001 168 | 33 | 158 001 721 | 22 |
| 158 001 045 | 30 | 158 001 107 | 31 | 158 001 169 | 33 | 158 001 722 | 22 |
| 158 001 046 | 30 | 158 001 108 | 31 | 158 001 170 | 33 | 158 001 777 | 25 |
| 158 001 047 | 30 | 158 001 109 | 31 | 158 001 171 | 33 | 158 001 778 | 25 |
| 158 001 048 | 30 | 158 001 110 | 31 | 158 001 172 | 33 | 158 001 779 | 25 |
| 158 001 049 | 30 | 158 001 111 | 31 | 158 001 173 | 34 | 158 001 919 | 23 |
| 158 001 050 | 30 | 158 001 112 | 31 | 158 001 174 | 33 | 158 001 920 | 23 |
| 158 001 051 | 30 | 158 001 113 | 31 | 158 001 175 | 34 | 158 050 498 | 27 |
| 158 001 052 | 30 | 158 001 114 | 31 | 158 001 176 | 34 | 158 400 001 | 10 |
| 158 001 053 | 30 | 158 001 115 | 31 | 158 001 177 | 34 | 158 400 002 | 10 |
| 158 001 054 | 30 | 158 001 116 | 31 | 158 001 178 | 34 | 158 400 003 | 10 |
| 158 001 055 | 30 | 158 001 117 | 31 | 158 001 179 | 34 | 158 400 004 | 10 |
| 158 001 056 | 30 | 158 001 118 | 31 | 158 001 180 | 34 | 158 400 005 | 10 |
| 158 001 057 | 30 | 158 001 119 | 31 | 158 001 181 | 34 | 158 400 006 | 10 |
| 158 001 058 | 30 | 158 001 120 | 31 | 158 001 182 | 34 | 158 400 007 | 10 |
| 158 001 059 | 30 | 158 001 121 | 31 | 158 001 183 | 34 | 158 400 008 | 10 |
| 158 001 060 | 30 | 158 001 122 | 31 | 158 001 184 | 34 | 158 400 009 | 10 |
| 158 001 061 | 30 | 158 001 123 | 31 | 158 001 185 | 34 | 158 400 010 | 15 |
| 158 001 062 | 30 | 158 001 124 | 31 | 158 001 590 | 37 | 158 400 011 | 15 |
| 158 001 063 | 30 | 158 001 125 | 33 | 158 001 591 | 37 | 158 400 012 | 15 |
| 158 001 064 | 30 | 158 001 126 | 33 | 158 001 592 | 37 | 158 400 013 | 15 |
| 158 001 065 | 30 | 158 001 127 | 33 | 158 001 593 | 37 | 158 400 014 | 15 |
| 158 001 066 | 30 | 158 001 128 | 33 | 158 001 594 | 37 | 158 400 015 | 15 |
| 158 001 067 | 30 | 158 001 129 | 33 | 158 001 595 | 37 | 158 400 016 | 15 |
| 158 001 068 | 30 | 158 001 130 | 33 | 158 001 596 | 37 | 158 400 017 | 15 |
| 158 001 069 | 30 | 158 001 131 | 33 | 158 001 597 | 37 | 158 400 018 | 15 |
| 158 001 070 | 30 | 158 001 132 | 33 | 158 001 598 | 37 | 158 400 019 | 15 |
| 158 001 071 | 30 | 158 001 133 | 33 | 158 001 599 | 37 | 158 400 020 | 15 |
| 158 001 072 | 30 | 158 001 134 | 33 | 158 001 600 | 37 | 158 400 021 | 15 |
| 158 001 073 | 30 | 158 001 135 | 33 | 158 001 601 | 37 | 158 400 022 | 14 |
| 158 001 074 | 30 | 158 001 136 | 33 | 158 001 602 | 37 | 158 400 023 | 14 |
| 158 001 075 | 30 | 158 001 137 | 33 | 158 001 605 | 37 | 158 400 024 | 14 |
| 158 001 076 | 30 | 158 001 138 | 33 | 158 001 606 | 37 | 158 400 025 | 14 |
| 158 001 077 | 30 | 158 001 139 | 33 | 158 001 607 | 37 | 158 400 026 | 14 |
| 158 001 078 | 30 | 158 001 140 | 33 | 158 001 608 | 37 | 158 400 027 | 14 |
| 158 001 079 | 30 | 158 001 141 | 33 | 158 001 609 | 37 | 158 400 028 | 14 |
| 158 001 080 | 30 | 158 001 142 | 33 | 158 001 610 | 37 | 158 400 029 | 14 |
| 158 001 081 | 30 | 158 001 143 | 33 | 158 001 611 | 37 | 158 400 030 | 14 |
| 158 001 082 | 30 | 158 001 144 | 33 | 158 001 612 | 37 | 158 400 031 | 14 |
| 158 001 083 | 30 | 158 001 145 | 33 | 158 001 613 | 37 | 158 400 032 | 14 |
| 158 001 084 | 30 | 158 001 146 | 33 | 158 001 614 | 37 | 158 400 033 | 14 |
| 158 001 085 | 30 | 158 001 147 | 33 | 158 001 615 | 37 | 158 400 034 | 14 |
| 158 001 086 | 30 | 158 001 148 | 33 | 158 001 616 | 37 | 158 400 035 | 14 |
| 158 001 087 | 30 | 158 001 149 | 33 | 158 001 617 | 37 | 158 400 036 | 14 |
| 158 001 088 | 30 | 158 001 150 | 33 | 158 001 618 | 37 | 158 400 037 | 15 |
| 158 001 089 | 31 | 158 001 151 | 33 | 158 001 619 | 37 | 158 400 038 | 15 |
| 158 001 090 | 30 | 158 001 152 | 33 | 158 001 620 | 37 | 158 400 039 | 15 |
| 158 001 091 | 31 | 158 001 153 | 33 | 158 001 621 | 37 | 158 400 040 | 15 |
| 158 001 092 | 31 | 158 001 154 | 33 | 158 001 622 | 37 | 158 400 041 | 15 |
| 158 001 093 | 31 | 158 001 155 | 33 | 158 001 623 | 37 | 158 400 042 | 15 |
| 158 001 094 | 31 | 158 001 156 | 33 | 158 001 624 | 37 | 158 400 043 | 15 |
| 158 001 095 | 31 | 158 001 157 | 33 | 158 001 625 | 37 | 158 400 044 | 15 |
| 158 001 096 | 31 | 158 001 158 | 33 | 158 001 626 | 37 | 158 400 045 | 15 |
| 158 001 097 | 31 | 158 001 159 | 33 | 158 001 627 | 37 | 158 400 046 | 15 |
| 158 001 098 | 31 | 158 001 160 | 33 | 158 001 713 | 22 | 158 400 047 | 13 |
| 158 001 099 | 31 | 158 001 161 | 33 | 158 001 714 | 22 | 158 400 048 | 13 |
| 158 001 100 | 31 | 158 001 162 | 33 | 158 001 715 | 22 | 158 400 049 | 13 |
| 158 001 101 | 31 | 158 001 163 | 33 | 158 001 716 | 22 | 158 400 050 | 13 |
| 158 001 102 | 31 | 158 001 164 | 33 | 158 001 717 | 22 | 158 400 051 | 13 |

Index

| Code | Page | Code | Page | Code | Page | Code | Page |
|-------------|------|-------------|------|-------------|------|-------------|------|
| 158 400 052 | 13 | 158 400 114 | 16 | 158 400 176 | 10 | 158 400 238 | 11 |
| 158 400 053 | 13 | 158 400 115 | 16 | 158 400 177 | 12 | 158 400 239 | 11 |
| 158 400 054 | 13 | 158 400 116 | 16 | 158 400 178 | 12 | 158 400 240 | 11 |
| 158 400 055 | 13 | 158 400 117 | 16 | 158 400 179 | 12 | 158 400 241 | 11 |
| 158 400 056 | 13 | 158 400 118 | 16 | 158 400 180 | 12 | 158 400 242 | 11 |
| 158 400 057 | 13 | 158 400 119 | 16 | 158 400 181 | 12 | 158 400 244 | 20 |
| 158 400 058 | 13 | 158 400 120 | 16 | 158 400 182 | 12 | 158 400 245 | 20 |
| 158 400 059 | 13 | 158 400 121 | 16 | 158 400 183 | 12 | 158 400 246 | 20 |
| 158 400 060 | 13 | 158 400 122 | 16 | 158 400 184 | 12 | 158 400 247 | 20 |
| 158 400 061 | 13 | 158 400 123 | 8 | 158 400 185 | 12 | 158 400 248 | 20 |
| 158 400 062 | 13 | 158 400 124 | 8 | 158 400 186 | 12 | 158 400 249 | 20 |
| 158 400 063 | 13 | 158 400 125 | 8 | 158 400 187 | 12 | 158 400 250 | 20 |
| 158 400 064 | 14 | 158 400 126 | 8 | 158 400 188 | 12 | 158 400 251 | 20 |
| 158 400 065 | 14 | 158 400 127 | 8 | 158 400 189 | 12 | 158 400 252 | 20 |
| 158 400 066 | 14 | 158 400 128 | 8 | 158 400 190 | 12 | 158 400 254 | 19 |
| 158 400 067 | 14 | 158 400 129 | 8 | 158 400 191 | 12 | 158 400 255 | 19 |
| 158 400 068 | 14 | 158 400 130 | 8 | 158 400 192 | 12 | 158 400 256 | 19 |
| 158 400 069 | 14 | 158 400 131 | 8 | 158 400 193 | 12 | 158 400 257 | 19 |
| 158 400 070 | 13 | 158 400 132 | 8 | 158 400 194 | 12 | 158 400 258 | 19 |
| 158 400 071 | 13 | 158 400 133 | 8 | 158 400 195 | 13 | 158 400 259 | 19 |
| 158 400 072 | 13 | 158 400 134 | 8 | 158 400 196 | 13 | 158 400 260 | 19 |
| 158 400 073 | 13 | 158 400 135 | 8 | 158 400 197 | 13 | 158 400 261 | 19 |
| 158 400 074 | 13 | 158 400 136 | 8 | 158 400 198 | 13 | 158 400 262 | 19 |
| 158 400 075 | 13 | 158 400 137 | 8 | 158 400 199 | 13 | 158 400 263 | 20 |
| 158 400 076 | 13 | 158 400 138 | 8 | 158 400 200 | 11 | 158 400 264 | 20 |
| 158 400 077 | 13 | 158 400 139 | 8 | 158 400 201 | 11 | 158 400 265 | 20 |
| 158 400 078 | 13 | 158 400 140 | 8 | 158 400 202 | 12 | 158 400 266 | 19 |
| 158 400 079 | 16 | 158 400 141 | 8 | 158 400 203 | 12 | 158 400 267 | 19 |
| 158 400 080 | 16 | 158 400 142 | 8 | 158 400 204 | 12 | 158 400 268 | 19 |
| 158 400 081 | 16 | 158 400 143 | 8 | 158 400 205 | 12 | 158 400 269 | 19 |
| 158 400 082 | 16 | 158 400 144 | 8 | 158 400 206 | 12 | 158 400 270 | 19 |
| 158 400 083 | 16 | 158 400 145 | 8 | 158 400 207 | 12 | 158 400 271 | 19 |
| 158 400 084 | 16 | 158 400 146 | 8 | 158 400 208 | 12 | 158 400 272 | 19 |
| 158 400 085 | 16 | 158 400 147 | 8 | 158 400 209 | 12 | 158 400 273 | 19 |
| 158 400 086 | 16 | 158 400 148 | 8 | 158 400 210 | 12 | 158 400 274 | 19 |
| 158 400 087 | 16 | 158 400 149 | 8 | 158 400 211 | 12 | 158 400 275 | 19 |
| 158 400 088 | 8 | 158 400 150 | 8 | 158 400 212 | 12 | 158 400 276 | 19 |
| 158 400 089 | 8 | 158 400 151 | 8 | 158 400 213 | 12 | 158 400 277 | 19 |
| 158 400 090 | 8 | 158 400 152 | 8 | 158 400 214 | 12 | 158 400 278 | 19 |
| 158 400 091 | 9 | 158 400 153 | 9 | 158 400 215 | 12 | 158 400 279 | 19 |
| 158 400 092 | 9 | 158 400 154 | 9 | 158 400 216 | 12 | 158 400 280 | 19 |
| 158 400 093 | 9 | 158 400 155 | 9 | 158 400 217 | 12 | 158 400 281 | 16 |
| 158 400 094 | 9 | 158 400 156 | 9 | 158 400 218 | 12 | 158 400 282 | 16 |
| 158 400 095 | 9 | 158 400 157 | 9 | 158 400 219 | 12 | 158 400 283 | 16 |
| 158 400 096 | 9 | 158 400 158 | 9 | 158 400 220 | 12 | 158 400 284 | 16 |
| 158 400 097 | 9 | 158 400 159 | 9 | 158 400 221 | 12 | 158 400 285 | 16 |
| 158 400 098 | 9 | 158 400 160 | 9 | 158 400 222 | 12 | 158 400 286 | 17 |
| 158 400 099 | 9 | 158 400 161 | 9 | 158 400 223 | 11 | 158 400 287 | 17 |
| 158 400 100 | 9 | 158 400 162 | 9 | 158 400 224 | 11 | 158 400 288 | 17 |
| 158 400 101 | 9 | 158 400 163 | 9 | 158 400 225 | 11 | 158 400 289 | 17 |
| 158 400 102 | 9 | 158 400 164 | 9 | 158 400 226 | 11 | 158 400 290 | 17 |
| 158 400 103 | 9 | 158 400 165 | 9 | 158 400 227 | 11 | 158 400 291 | 17 |
| 158 400 104 | 9 | 158 400 166 | 9 | 158 400 228 | 11 | 158 400 292 | 17 |
| 158 400 105 | 9 | 158 400 167 | 9 | 158 400 229 | 11 | 158 400 293 | 17 |
| 158 400 106 | 9 | 158 400 168 | 10 | 158 400 230 | 11 | 158 400 294 | 17 |
| 158 400 107 | 9 | 158 400 169 | 10 | 158 400 231 | 11 | 158 400 295 | 17 |
| 158 400 108 | 9 | 158 400 170 | 10 | 158 400 232 | 11 | 158 400 296 | 17 |
| 158 400 109 | 9 | 158 400 171 | 10 | 158 400 233 | 11 | 158 400 297 | 17 |
| 158 400 110 | 9 | 158 400 172 | 10 | 158 400 234 | 11 | 158 400 300 | 18 |
| 158 400 111 | 9 | 158 400 173 | 10 | 158 400 235 | 11 | 158 400 301 | 17 |
| 158 400 112 | 9 | 158 400 174 | 10 | 158 400 236 | 11 | 158 400 302 | 17 |
| 158 400 113 | 9 | 158 400 175 | 10 | 158 400 237 | 11 | 158 400 303 | 17 |

Index

| Code | Page | Code | Page | Code | Page |
|-------------|------|-------------|------|-------------|------|
| 158 400 304 | 18 | 727 627 054 | 27 | 727 627 167 | 28 |
| 158 400 305 | 18 | 727 627 055 | 27 | 727 627 168 | 28 |
| 158 400 306 | 18 | 727 627 061 | 27 | 727 627 176 | 28 |
| 158 400 307 | 18 | 727 627 062 | 27 | 727 627 177 | 28 |
| 158 400 308 | 18 | 727 627 063 | 27 | 727 627 178 | 28 |
| 158 400 309 | 18 | 727 627 064 | 27 | | |
| 158 400 310 | 18 | 727 627 065 | 27 | | |
| 158 400 311 | 18 | 727 627 066 | 27 | | |
| 158 400 312 | 18 | 727 627 071 | 27 | | |
| 158 400 313 | 18 | 727 627 072 | 27 | | |
| 158 400 314 | 18 | 727 627 073 | 27 | | |
| 158 400 315 | 18 | 727 627 074 | 27 | | |
| 158 400 316 | 18 | 727 627 075 | 27 | | |
| 158 400 317 | 18 | 727 627 076 | 27 | | |
| 158 400 318 | 18 | 727 627 082 | 27 | | |
| 158 400 319 | 18 | 727 627 083 | 27 | | |
| 158 400 320 | 18 | 727 627 084 | 27 | | |
| 158 400 321 | 18 | 727 627 085 | 27 | | |
| 158 400 322 | 18 | 727 627 086 | 27 | | |
| 158 400 323 | 20 | 727 627 087 | 27 | | |
| 158 400 324 | 20 | 727 627 091 | 27 | | |
| 158 400 325 | 20 | 727 627 092 | 27 | | |
| 158 400 326 | 20 | 727 627 093 | 27 | | |
| 158 400 327 | 20 | 727 627 094 | 27 | | |
| 158 400 328 | 20 | 727 627 095 | 27 | | |
| 158 400 340 | 17 | 727 627 096 | 27 | | |
| 158 400 341 | 17 | 727 627 097 | 27 | | |
| 158 400 342 | 17 | 727 627 098 | 27 | | |
| 158 400 350 | 10 | 727 627 101 | 27 | | |
| 158 400 351 | 8 | 727 627 102 | 27 | | |
| 158 400 352 | 8 | 727 627 103 | 27 | | |
| 158 400 353 | 16 | 727 627 104 | 27 | | |
| 158 400 354 | 11 | 727 627 105 | 28 | | |
| 158 400 355 | 8 | 727 627 106 | 28 | | |
| 158 400 356 | 13 | 727 627 107 | 28 | | |
| 158 400 357 | 13 | 727 627 108 | 28 | | |
| 158 400 702 | 25 | 727 627 111 | 28 | | |
| 158 400 705 | 25 | 727 627 112 | 28 | | |
| 158 400 708 | 25 | 727 627 113 | 28 | | |
| 158 400 710 | 25 | 727 627 114 | 28 | | |
| 158 400 711 | 25 | 727 627 115 | 28 | | |
| 158 400 716 | 25 | 727 627 116 | 28 | | |
| 158 400 720 | 25 | 727 627 117 | 28 | | |
| 158 400 723 | 25 | 727 627 118 | 28 | | |
| 158 400 998 | 18 | 727 627 123 | 28 | | |
| 158 400 999 | 18 | 727 627 124 | 28 | | |
| 727 627 001 | 27 | 727 627 125 | 28 | | |
| 727 627 011 | 27 | 727 627 126 | 28 | | |
| 727 627 012 | 27 | 727 627 127 | 28 | | |
| 727 627 021 | 27 | 727 627 128 | 28 | | |
| 727 627 022 | 27 | 727 627 135 | 28 | | |
| 727 627 023 | 27 | 727 627 136 | 28 | | |
| 727 627 031 | 27 | 727 627 137 | 28 | | |
| 727 627 032 | 27 | 727 627 138 | 28 | | |
| 727 627 033 | 27 | 727 627 145 | 28 | | |
| 727 627 041 | 27 | 727 627 146 | 28 | | |
| 727 627 042 | 27 | 727 627 147 | 28 | | |
| 727 627 043 | 27 | 727 627 148 | 28 | | |
| 727 627 044 | 27 | 727 627 156 | 28 | | |
| 727 627 051 | 27 | 727 627 157 | 28 | | |
| 727 627 052 | 27 | 727 627 158 | 28 | | |
| 727 627 053 | 27 | 727 627 166 | 28 | | |

General Conditions of Supply

1. General

- 1.1 These general conditions shall apply to all goods supplied by Georg Fischer TPA srl to the Purchaser. They shall also apply to all future business even when no express reference is made to them.
- 1.2 Any deviating or supplementary conditions, especially Purchaser's general conditions of purchase, and verbal agreements shall only be applicable if accepted in writing by Georg Fischer TPA srl.

2. Tenders

Tenders shall only be binding if they contain a specifically stated period for acceptance.

3. Scope of Delivery

- 3.1 Georg Fischer TPA srl's product range is subject to change.
- 3.2 The confirmation of order shall govern the scope and execution of the contract.

4. Data and Documents

- 4.1 Technical documents such as drawings, descriptions, illustrations and data on dimensions, performance and weight as well as the reference to standards are for information purposes only. They are not warranted characteristics and are subject to change.
- 4.2 All technical documents shall remain the exclusive property of Georg Fischer TPA srl and may only be used for the agreed purposes or as Georg Fischer TPA srl may consent.
- 4.3 In the context of the contractual relation with the Purchaser personal data may be processed. The Purchaser agrees to the disclosure of said data to third parties, such as foreign subcontractors and suppliers etc.

5. Local Laws and Regulations

The Purchaser shall bring to the attention of Georg Fischer TPA srl all local laws and regulations at the place of destination which bear connection with the execution of the contract and the adherence to relevant safety regulations and approval procedures.

6. Prices

- 6.1 Unless agreed otherwise, the prices shall be deemed quoted net, ex works, including standard packing. All supplementary costs, such as the cost of carriage, insurance, export and import licences, etc. shall be borne by the Purchaser. The Purchaser shall also bear the costs of all taxes, fees, duties, etc. connected with the contract.
- 6.2 If the costs of packing, carriage, insurance, fees and other supplementary costs are included in the tender price or contract price or are referred to specifically in the tender or confirmation of order, Georg Fischer TPA srl reserve the right to revise their prices accordingly should any change occur in the relevant tariffs.

7. Payment

- 7.1 The Purchaser shall make payment in the manner agreed by the parties to the Georg Fischer works conducting the account without any deductions such as discounts, costs, taxes or dues.
- 7.2 The Purchaser may only withhold or off-set payments due against counter-claims which are either expressly acknowledged by Georg Fischer TPA srl or finally awarded to the Purchaser. In particular, payment shall still be made when unessential items are still outstanding provided, however, that the goods already delivered are not rendered unusable as a result.

8. Retention of Title

- 8.1 The goods shall remain the property of Georg Fischer TPA srl until the Purchaser shall have settled all claims, present and future, which Georg Fischer TPA srl may have against him.
- 8.2 Should the Purchaser sell goods to which title is reserved he shall then be deemed to have tacitly assigned to Georg Fischer TPA srl the proceeds deriving from their sale together with all collateral rights, securities and reservations of title until all claims held by Georg Fischer TPA srl shall have been settled.
- 8.3 To the extent the value of the goods to which title is reserved together with collateral securities should exceed Georg Fischer TPA srl's claims against the Purchaser by more than 20%, Georg Fischer TPA srl shall reassign the above proceeds to Purchaser at his request.
- 8.4 In case of default on the part of the Purchaser, in particular in case of arrears, Georg Fischer shall be entitled to repossession of the goods after having given notice to this effect, and the Purchaser shall be obligated to surrender the goods.

9. Delivery

- 9.1 The term of delivery shall commence as soon as the contract has been entered into, all official formalities such as import and payment permits have been obtained and all essential technical points have been settled. The term of delivery shall be deemed duly observed when, upon its expiry, the goods are ready for despatch.
- 9.2 Delivery is subject to the following conditions, i. e. the term of delivery shall be reasonably extended:
 - a) if Georg Fischer TPA srl are not supplied in time with the information necessary for the execution of the contract or if subsequent changes causing delays are made by the Purchaser.
 - b) if Georg Fischer TPA srl are prevented from performing the contract by force majeure. Force majeure shall equally be deemed to be any unforeseeable event beyond Georg Fischer TPA srl's control which renders Georg Fischer TPA srl's performance commercially unpracticable or impossible, such as delayed or defective supplies from subcontractors, labour disputes, governmental orders or regulations, shortages in materials or energy, serious disturbances in Georg Fischer TPA srl's works, such as the total or partial destruction of plant and equipment or the breakdown of essential facilities, serious disruptions in transport facilities, e.g. impassable roads. Should the effect of force majeure exceed a period of six months, either party may cancel the contract forthwith. Georg Fischer TPA srl shall not be liable for any damage or loss of any kind whatsoever resulting therefrom, any suspension or cancellation being without prejudice to Georg Fischer TPA srl's right to recover all sums due in respect of consignments delivered and costs incurred to date.
 - c) if the Purchaser fails to fulfil or delays in fulfilling his obligations under the contract, in particular if he does not adhere to the agreed conditions of payment.
- 9.3 If for reasons attributable to Georg Fischer TPA srl a reasonable term of delivery is exceeded, Georg Fischer TPA srl shall not be deemed in default until the Purchaser has granted to Georg Fischer TPA srl in writing a reasonable extension thereof of not less than one month which equally is not met. The Purchaser shall then be entitled to cancel the contract.

- 9.4 If the Purchaser fails to take delivery within a reasonable time of goods notified as ready for despatch, Georg Fischer TPA srl shall be entitled to store the goods at the Purchaser's expense and risk and to invoice them as delivered.
- 9.5 Partial shipments shall be allowed and Georg Fischer TPA srl shall be entitled to invoice for such deliveries.
- 9.6 If Georg Fischer TPA srl do not insist on the performance of a contract cancelled by the Purchaser, a penalty of 10% of the contract price shall become due unless Georg Fischer TPA srl can prove greater damages.
10. **Packing**
If the goods are provided with additional packing over and above the standard packing, such packing shall be invoiced separately and be non-returnable.
11. **Passing of Risk**
 - 11.1 The risk in the goods shall pass to the Purchaser as soon as they have left Georg Fischer TPA srl's works, even if delivery is made carriage-paid, under similar clauses or including installation or when carriage is organized and managed by Georg Fischer TPA srl.
 - 11.2 If delivery is delayed for reasons beyond Georg Fischer TPA srl's control, the risk shall pass to the Purchaser when he is notified that the goods are ready for despatch.
12. **Carriage and Insurance**
 - 12.1 Unless agreed otherwise, the Purchaser shall bear the cost of carriage.
 - 12.2 The Purchaser shall be responsible for insurance against damage of whatever kind. Even when such insurance is arranged by Georg Fischer TPA srl it shall be deemed taken out by the order of and for the account of the Purchaser and at his risk.
 - 12.3 Special requests regarding carriage and insurance shall be communicated to Georg Fischer TPA srl in due time. Otherwise carriage shall be arranged by Georg Fischer TPA srl at their discretion, but without responsibility, by the quickest and cheapest method possible.
In case of carriage-paid delivery transport arrangements shall be made by Georg Fischer TPA srl. If the Purchaser specifies particular requirements, any extra costs involved shall be borne by him.
 - 12.4 In the event of damage or loss of the goods during carriage the Purchaser shall mark the delivery documents accordingly and immediately have the damage ascertained by the carrier.
Not readily ascertainable damages sustained during carriage shall be notified to the carrier within six days after receipt of the goods.
13. **Inspection and Acceptance**
 - 13.1 The goods will be subject to normal inspection by Georg Fischer TPA srl during manufacture. Additional tests required by the Purchaser shall be agreed upon in writing and shall be charged to the Purchaser.
 - 13.2 It shall be a condition of Georg Fischer TPA srl's obligation under the warranties stated hereinafter that Georg Fischer TPA srl be notified in writing by the Purchaser of any purported defect immediately upon discovery. Notice concerning weight, numbers or apparent defects is to be given latest within 30 days from receipt of the goods, notice of other defects latest within the agreed warranty period.
14. **Warranty**
 - 14.1 At the written request of the Purchaser, Georg Fischer TPA srl undertake to repair or replace, at their discretion, as quickly as possible and free of charge all goods supplied which demonstrably suffer from faulty design, materials or workmanship or from faulty operation or installation instructions. Replaced parts shall become property of Georg Fischer TPA srl.
 - 14.2 The Purchaser shall be entitled to cancel the contract or to demand a reduction in the contract price if:
 - repair or replacement is impossible, or
 - Georg Fischer TPA srl are unable or refuse to remedy the defect or replace the defective goods within a reasonable period of time or are unduly delaying such remedy or replacement.
 - 14.3 For goods which are manufactured to specifications, drawings or patterns supplied by the Purchaser, Georg Fischer TPA srl's warranty shall be restricted to proper materials and workmanship.
 - 14.4 This warranty shall not apply to damage resulting from normal wear, improper storage and maintenance, failure to observe the operating instructions, overstressing or overloading, unsuitable operating media, improper repairs or alterations by the Purchaser or third parties, the use of non-genuine parts and other reasons beyond Georg Fischer TPA srl's control.
 - 14.5 For goods or essential components manufactured by a third party and supplied by Georg Fischer TPA srl under this contract, Georg Fischer TPA srl's warranty is limited to the warranty provided by said third party.
 - 14.6 No action or claim may be brought by the Purchaser on account of any alleged breach of warranty or any other obligation of Georg Fischer TPA srl after the expiration of twelve (12) months from receipt of the goods by the end user or at the latest within eighteen (18) months of the goods being despatched by Georg Fischer TPA srl.
15. **Limitation of Liability**
The warranties set forth above are expressly in lieu of any express warranty of any kind and in lieu of any implied warranty, including any warranty of merchantability or fitness for a particular purpose. Georg Fischer TPA srl shall not be liable for any incidental special or consequential damages, such as loss of profits, loss of production, loss of use or loss of contract, arising for any reason, including damages resulting from delayed delivery, defective design, materials or workmanship or from faulty instructions and whether such damages are claimed to arise from breach of contract, in tort, the theory of product liability or otherwise; reservation is solely being made for Georg Fischer TPA srl's statutory liability due to material breach of an essential contractual obligation, express representations, wrongful intent, gross negligence or product liability acts.
16. **Place of Performance and Jurisdiction**
 - 16.1 Place of performance for the goods shall be the Georg Fischer TPA srl works from which the goods are despatched.
 - 16.2 Any civil action based upon any alleged breach of this contract shall be filed and prosecuted exclusively in the courts having jurisdiction over the Georg Fischer TPA srl works invoicing the goods. Georg Fischer TPA srl however reserves the right to file actions in any court having jurisdiction over controversies arising out of or in connection with the present contract.
 - 16.3 The contract shall be governed by the law applicable at the place of business of the Georg Fischer TPA srl works invoicing the goods in question.

Worldwide at Home

Our sales companies and representatives ensure local customer support in over 100 countries

www.gfps.com

Argentina / Southern South America

Georg Fischer Central Plastics Sudamérica S.R.L.
Buenos Aires, Argentina
Phone +54 11 4512 02 90
gfccentral.ps.ar@georgfischer.com
www.gfps.com/ar

Australia

Georg Fischer Pty Ltd
Riverwood NSW 2210 Australia
Phone +61 (0) 2 9502 8000
australia.ps@georgfischer.com
www.gfps.com/au

Austria

Georg Fischer Rohrleitungssysteme GmbH
3130 Herzogenburg
Phone +43 (0) 2782 856 43-0
austria.ps@georgfischer.com
www.gfps.com/at

Georg Fischer Fittings GmbH
3160 Traisen
Phone +43 (0) 2762 90300
fittings.ps@georgfischer.com
www.fittings.at

Belgium / Luxembourg

Georg Fischer NV/SA
1070 Bruxelles/Brüssel
Phone +32 (0) 2 556 40 20
be.ps@georgfischer.com
www.gfps.com/be

Brazil

Georg Fischer Sist. de Tub. Ltda.
04571-020 São Paulo/SP
Phone +55 (0) 11 5525 1311
br.ps@georgfischer.com
www.gfps.com/br

Canada

Georg Fischer Piping Systems Ltd
Mississauga, ON L5T 2B2
Phone +1 (905) 670 8005
Fax +1 (905) 670 8513
ca.ps@georgfischer.com
www.gfps.com/ca

China

Georg Fischer Piping Systems Ltd
Shanghai 201319
Phone +86 21 3899 3899
china.ps@georgfischer.com
www.gfps.com/cn

Chinaust Plastics Corp. Ltd.
Songliandian, Zhuozhou city,
Hebei province, China, 072761
Phone +86 312 395 2000
Fax +86 312 365 2222
chinaust@chinaust.com
www.chinaust.com.cn

Denmark / Iceland

Georg Fischer A/S
2630 Taastrup
Phone +45 (0) 70 22 19 75
info.dk.ps@georgfischer.com
www.gfps.com/dk

Finland

Georg Fischer AB
01510 VANTAA
Phone +358 (0) 9 586 58 25
Fax +358 (0) 9 586 58 29
info.fi.ps@georgfischer.com
www.gfps.com/fi

France

Georg Fischer SAS
95932 Roissy Charles de Gaulle Cedex
Phone +33 (0) 1 41 84 68 84
fr.ps@georgfischer.com
www.gfps.com/fr

Germany

Georg Fischer GmbH
73095 Albershausen
Phone +49 (0) 7161 302 0
info.de.ps@georgfischer.com
www.gfps.com/de

India

Georg Fischer Piping Systems Pvt. Ltd
400 083 Mumbai
Phone +91 22 4007 2000
Fax +91 22 4007 2020
branchoffice@georgfischer.com
www.gfps.com/in

Italy

Georg Fischer S.p.A.
20063 Cernusco S/N (MI)
Phone +39 02 921 861
it.ps@georgfischer.com
www.gfps.com/it

Georg Fischer TPA S.r.l.
IT-16012 Busalla (GE)
Phone +39 010 962 47 11
tpa.ps@georgfischer.com
www.gfps.com/it

Japan

Georg Fischer Ltd
530-0003 Osaka
Phone +81 (0) 6 6341 2451
jp.ps@georgfischer.com
www.gfps.com/jp

Korea

Georg Fischer Korea Co. Ltd
Unit 2501, U-Tower
120 HeungdeokJungang-ro
(Yeongdeok-dong)
Giheung-gu, Yongin-si, Gyeonggi-do
Phone +82 31 8017 1450
Fax +82 31 217 1454
kor.ps@georgfischer.com
www.gfps.com/kr

Malaysia

Georg Fischer (M) Sdn. Bhd.
40460 Shah Alam, Selangor Darul Ehsan
Phone +60 (0) 3 5122 5585
Fax +60 (0) 3 5122 5575
my.ps@georgfischer.com
www.gfps.com/my

Mexico / Northern Latin America

Georg Fischer S.A. de C.V.
Apodaca, Nuevo Leon
CP66636 Mexico
Phone +52 (81) 1340 8586
Fax +52 (81) 1522 8906
mx.ps@georgfischer.com
www.gfps.com/mx

Middle East

Georg Fischer Piping Systems (Switzerland) Ltd
Dubai, United Arab Emirates
Phone +971 4 289 49 60
gcc.ps@georgfischer.com
www.gfps.com/int

Netherlands

Georg Fischer N.V.
8161 PA Epe
Phone +31 (0) 578 678 222
nl.ps@georgfischer.com
www.gfps.com/nt

Georg Fischer Waga N.V.

NL-8160 AG Epe
Phone +31 (0) 578 678 378
waga.ps@georgfischer.com
www.waga.nl

Norway

Georg Fischer AS
1351 Rud
Phone +47 67 18 29 00
no.ps@georgfischer.com
www.gfps.com/no

Poland

Georg Fischer Sp. z o.o.
05-090 Sekocin Nowy
Phone +48 (0) 22 31 31 0 50
poland.ps@georgfischer.com
www.gfps.com/pt

Romania

Georg Fischer Piping Systems (Switzerland) Ltd
020257 Bucharest - Sector 2
Phone +40 (0) 21 230 53 80
ro.ps@georgfischer.com
www.gfps.com/int

Russia

Georg Fischer Piping Systems (Switzerland) Ltd
Moscow 125040
Phone +7 495 748 11 44
ru.ps@georgfischer.com
www.gfps.com/ru

Singapore

Georg Fischer Pte Ltd
11 Tampines Street 92, #04-01/07
528 872 Singapore
Phone +65 6747 0611
Fax +65 6747 0577
sgp.ps@georgfischer.com
www.gfps.com/sg

Spain / Portugal

Georg Fischer S.A.
28046 Madrid
Phone +34 (0) 91 781 98 90
es.ps@georgfischer.com
www.gfps.com/es

Sweden

Georg Fischer AB
117 43 Stockholm
Phone +46 (0) 8 506 775 00
info.se.ps@georgfischer.com
www.gfps.com/se

Switzerland

Georg Fischer Rohrleitungssysteme (Schweiz) AG
8201 Schaffhausen
Phone +41 (0) 52 631 3026
ch.ps@georgfischer.com
www.gfps.com/ch

Taiwan

Georg Fischer Co. Ltd
San Chung Dist., New Taipei City
Phone +886 2 8512 2822
Fax +886 2 8512 2823
www.gfps.com/tw

United Kingdom / Ireland

Georg Fischer Sales Limited
Coventry, CV2 2ST
Phone +44 (0) 2476 535 535
uk.ps@georgfischer.com
www.gfps.com/uk

USA / Caribbean

Georg Fischer LLC
9271 Jeronimo Road
92618 Irvine, CA
Phone +1 714 731 88 00
Fax +1 714 731 62 01
us.ps@georgfischer.com
www.gfps.com/us

Georg Fischer Central Plastics LLC
Shawnee, OK 74801
Phone +1 (405) 273 63 02
gfccentral.ps@georgfischer.com
www.centralplastics.com

International

Georg Fischer Piping Systems (Switzerland) Ltd
8201 Schaffhausen/Switzerland
Phone +41 (0) 52 631 3003
Fax +41 (0) 52 631 2893
info.export@georgfischer.com
www.gfps.com/int

The technical data are not binding. They neither constitute expressly warranted characteristics nor guaranteed properties nor a guaranteed durability. They are subject to modification. Our General Terms of Sale apply.



GFDO_6227_4c (11.16)

© Georg Fischer Piping Systems Ltd
CH-8201 Schaffhausen/Switzerland, 2016